

宁波杰克龙精工有限公司
宁波杰克龙水表有限公司

地址：中国·宁波·慈城城西西路1号
Address: No.1 Chengxi West Road Cicheng Ningbo China
销售热线(Sales hotline): +86-574-87597291
服务热线(Service hotline): +86-574-87597992
全国免费服务热线(The free service hotline): 800-9574-099
投诉专线(Complaint special line): +86-574-87574567
传真(Fax): +86-574-87574862-1318
邮编(P.C.): 315034
网址(Http): www.jklong.com
电子信箱(E-mail): sales@jklong.com

JKLONG-SI01-1-A2/Jun 2017

版权所有 禁止仿冒 All information are subject to changes without notice all copyright are reserved



PRECISE PROCESSING, OUTSTANDING SERVICE

| 卓越精工 | 自然出众 |

综合产品目录
Integrated Catalog

JKLONG 杰克龙®
www.jklong.com



卓越精工，自然出众！

品牌是社会的，也是企业的载体，
铸造品牌，即是贡献社会，传播品牌，
即是传播企业的形象。

目录

Content

公司简介 Company Profile	生产设备 Production Equipment	市场与销售 Market and Sale	水司系列 Water Company Series
			06-13
品牌价值 Brand Value	研发与创新 R&D and Innovations	品质管理 Quality Management	中央空调系列 Central Air-conditioning Series
			02-05

采暖产品系列 HVAC Series	锁式阀门系列 Lockable Valves Series	小五金系列 Hardware Series	给排水阀门系列 Water Supply&Drainage Valves Series	
28-36	41-45	49-50	55-57	
燃气阀门系列 Gas valves Series	PPR阀门系列 PPR Valves Series	法兰系列 Flanged Valves Series	水表系列 Water Meters Series	现有其它产品 Other Available Items
14-27	37-40	46-48	51-54	58-59



Company Profile 公司简介

宁波杰克龙精工有限公司始建于1998年8月，是中国500强企业—宁波金田铜业（集团）股份有限公司的全资子公司。公司致力于铜阀门的研发、制造、销售和服务，主要产品有铜阀门、铸钢、铸铁阀门、燃气阀、水暖卫浴、水表及各类管件等，产品广泛应用于给排水系统、燃气系统、城市供热、暖通空调及产品配套等领域。公司销售网络遍布全国32个省市自治区，销售网点近400家，在中国中低压民用铜阀门领域中名列前茅。

宁波金田铜业（集团）股份有限公司是中国最大的铜加工企业之一，2013年位列中国企业500强第327位。公司技术中心凭借自身完善的研发体制、雄厚的科技实力和丰硕的科研成果，被国家发改委认定为“国家级企业技术中心”；公司致力于环境保护和生态建设，被评为全国首批“城市矿产”示范基地。

宁波杰克龙精工有限公司先后通过了ISO9001、ISO14001和OHSAS18001三大管理体系认证，被评为“高新技术企业”。“杰克龙”商号被认定为浙江省知名商号，杰克龙品牌被评为“中国阀门知名品牌”。公司以金田集团定制铜棒作为原材料，保证了产品的品质。公司坚持科技兴企理念，专注于产品的研发与技术创新，拥有产品专利二十余项。公司拥有一支具有丰富行业经验的研发队伍，配备了行业领先的自动化生产设备和检测设备，采用先进的热锻红外线测温系统，引进CNC多轴精加工专机、三坐标仪、100%密封性能检测及阀门寿命测试设备，凭借一整套严格的产品管理体系和从原料到成品的全过程监控，有力保障了杰克龙产品的高品质，打造了杰克龙出众的品牌优势，赢得了广大用户的认可与信任。

公司坚持走循环经济与清洁生产和谐发展之路，秉承“品牌共创，成就共享，合作共赢，和谐共建”的发展理念，竭尽众智，创新经营，致力于让“杰克龙”成为业内第一品牌和世界著名品牌，用我们真诚的服务，开启您的美好生活。

Ningbo Jiekelong Precision Manufacturing Co.,Ltd. founded in August 1998, is the wholly-owned subsidiary company of Ningbo Jintian Copper (Group) Co., Ltd., of which is China Top 500 Enterprises. The company is dedicating in R&D, manufacture, sales and service of brass valves. Products are widely used in the fields of water supply and drainage system, gas system, urban heating, HVAC, ancillary products, etc., which mainly cover brass valve, cast steel&cast iron valve, gas valve, heating equipment and sanitary ware, water meter and various kinds of pipe fittings. Nearly 400 sales outlets throughout 32 provinces of the country contribute to our wide sales network with top reputation in the processing of low and medium civil brass valves in China.

Ningbo Jintian Copper (Group) Co., Ltd. ranking No. 327 among Top 500 Enterprises of China, but is the largest copper processing enterprise of China. With comprehensive R&D system, strong technology advantages and fruitful scientific research works, the enterprise technology center, is identified as "State-Level Enterprise Technology Center" by National Development and Reform Commission.

JKlong Precision is recognized as the High Technology Enterprises and "Zhejiang Province Well-known Firm" with certificate of three management system, ISO9001, ISO14001 and OHSAS18001. "JKLONG" brand has been identified as "Famous brand of Chinese Valves". Company values high quality by exclusively applying Jintian brass bar, adheres to the concept of science and technology enterprise, focuses on products R&D and technological innovation, all which bring us dozens of product patents. The company owns a rich industry experience R&D team, equipped with industry-leading automated production equipment and testing equipment. JKlong products are effectively ensured high quality since the company takes customized Jintian copper bar as the material, adopts advanced infrared temperature measuring system for hot-pressing forging technology, CNC multi-axes finishmachining special machine, tri-coordinates thickness gauge, 100% sealing performance test and valve's service life testing equipments, reckons on strict products management system as well as whole process monitoring from the material to the finished product, to create the brand advantages that JKlong holds, and win the acceptance and confidence of spacious users.

The company always insists on the principle of harmonious development with circular economy and new-type industrialization, keeps cleanness production, Create brand together, share achievement together, win from cooperation together, build harmonious together", we are willing to collect our wisdom to make the "JKLong" become the first brand even the world famous brand of this line with continuously offering fresher and better service. Service exists everywhere, details show sincerity. Our faithful service is the key to your better life.

研发与创新 R&D And Innovations

拥有一支具有丰富设计经验的研发队伍，采用先进的计算机辅助设计软件和三维造型软件，设计的产品结构合理，外形美观，重量适中，具有很强的市场竞争力。拥有先进的加工设备及生产工艺，全力开发新产品以满足市场的需要，并多次获得国家专利。

We have a R&D team with rich experience in product design, and apply the leading CAD and 3-D modeling software. The products designed by us have reasonable construction, beautiful appearance, moderate weight and very good competitiveness. We also own advanced production equipment and technologies, and make great efforts to develop new products to meet the market demands. Besides we are granted many national patents.

技术创新 科技兴业

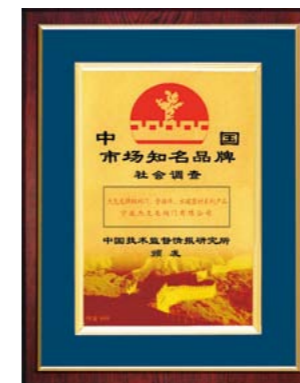

生产设备 Production Equipment

先进的生产设备，引进进口阀门专机，采用美标气压、水压测试，严格按照国际标准进行产品全检，尽显一流品质。技术专家全程监督生产，保证产品的始终高品质。产品广泛使用在石油、化工、污水处理、消防、建筑、自来水等行业中。

With leading production equipment and imported valve, we execute gas special plane & water pressure tests as per American standards. We carry out 100% product tests strictly according to international standards. In order to ensure first-class quality, our technical experts monitor the entire production process and guarantee high product quality all the time. Our products are widely applied in petroleum, chemical, wastewater treatment, fire protection, construction and drinkable water industries.





超声波清洗机 Ultrasonic cleaning machine



压力机 Press



台车式热风循环炉
Trolley-type hot air circulating furnace



立式转盘加工专机
Vertical turntable processing machine



生产设备 Production Equipment



品质管理 Quality Management

拥有先进的检测设备，有一支经验丰富的品质管理团队。通过ISO9001认证，严格按照质量管理体系的要求执行。质量要求做到精益求精，产品100%检测，通过持续不断的改进来满足客户的需求。

The company has advanced inspection instruments and a quality management team with rich experience. It has been certified by ISO9001 quality management system, and all its products are inspected strictly according to quality requirements so as to continually improve its product quality to meet customer's requirements.



- 引进进口阀门专机28台/套
- 采用美标气压、水压测试
- 严格按照国际标准进行产品全检
- 企业通过ISO9001质量体系认证
- 企业通过ISO14001环境管理体系认证

- It introduces over 28 sets of the imported valve special-purpose machine tool
- It employs American standard air & water pressure testing
- It strictly implements the full product inspection according to the international standard
- Our business passes ISO9001 quarantine somatotype
- Our business passes ISO14001 manage somatotype

严格控制 保证品质
Strict Control | Guarantee Quality



中央空调系列 CENTRAL AIR-CONDITIONING SERIES



9105 黄铜闸阀 Brass Gate Valve (Z15W-16T)

技术规范

公称压力: 1.6 MPa
工作介质: 水、非腐蚀性液体、饱和蒸汽($\leq 0.6\text{MPa}$)
工作温度: $-20^{\circ}\text{C} \leq t \leq 150^{\circ}\text{C}$
圆柱管螺纹符合ISO228标准

Technical Standard

Nominal Pressure: 1.6 Mpa
Working Medium: Water, Non-causticity liquid, Saturated steam($\leq 0.6\text{MPa}$)
Working Temperature: $-20^{\circ}\text{C} \leq t \leq 150^{\circ}\text{C}$
Parallel Pipe Thread to ISO228

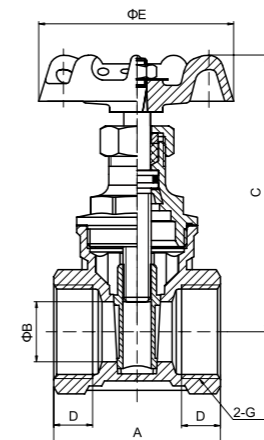

DN	A	B	C	D	E	G
15	43.5	13	72.5	10.5	54	1/2
20	47	17	78	11	54	3/4
25	52	21	91.5	13	60	1
32	57	27	105	13.5	72	1 1/4
40	60	34	117	14	72	1 1/2
50	69	45	143	16	80	2

9266 黄铜球阀 Brass Ball Valve (Q11F-16T)

技术规范

公称压力: 1.6 MPa
工作介质: 水、非腐蚀性液体
工作温度: $-10^{\circ}\text{C} \leq t \leq 100^{\circ}\text{C}$
圆柱管螺纹符合ISO228标准

Technical Standard

Nominal Pressure: 1.6 Mpa
Working Medium: Water, Non-causticity liquid
Working Temperature: $-10^{\circ}\text{C} \leq t \leq 100^{\circ}\text{C}$
Parallel Pipe Thread to ISO228

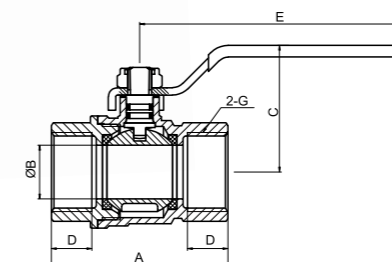

DN	A	B	C	D	E	G
15	52	13	39.1	12.5	90	1/2
20	59	18	42.4	13.5	90	3/4
25	71	24	55.3	14.5	110	1
32	81	30	60.8	15.5	140.2	1 1/4
40	93.2	37	66.7	16.5	140.2	1 1/2
50	111	49.5	78.2	18.5	155.3	2

311 黄铜截止阀 Brass Stop Valve (J11W-16T)

技术规范

公称压力: 1.6 MPa
工作介质: 水、非腐蚀性液体、饱和蒸汽($\leq 0.6\text{MPa}$)
工作温度: $-20^{\circ}\text{C} \leq t \leq 150^{\circ}\text{C}$
圆柱管螺纹符合ISO228标准

Technical Standard

Nominal Pressure: 1.6 Mpa
Working Medium: Water, Non-causticity Liquid, Saturated steam($\leq 0.6\text{MPa}$)
Working Temperature: $-20^{\circ}\text{C} \leq t \leq 150^{\circ}\text{C}$
Parallel Pipe Thread to ISO228

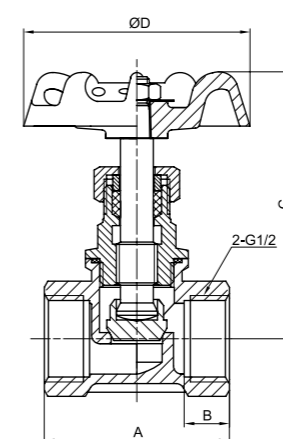

DN	Size	A	B	C	D	G
15	1/2	45	11	65-68.5	54	1/2
20	3/4	51	11	71-76	60	3/4
25	1	64.5	15	82-90	72	1
32	1 1/4	75	16	95.4-106.5	80	1 1/4
40	1 1/2	82	17	109-121	100	1 1/2
50	2	100	19	122.5-136	110	2

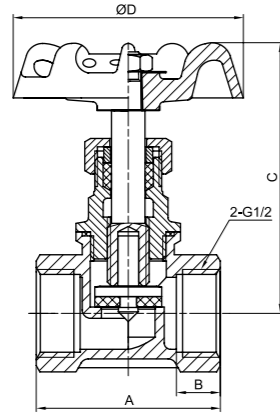

312 黄铜截止阀
Brass Stop Valve (J11F-16T)

技术规范
公称压力: 1.6 MPa
工作介质: 水、非腐蚀性液体、饱和蒸汽($\leq 0.6\text{MPa}$)
工作温度: $-20^{\circ}\text{C} \leq t \leq 120^{\circ}\text{C}$
圆柱管螺纹符合ISO228标准

Technical Standard
Nominal Pressure: 1.6 Mpa
Working Medium: Water, Non-causticity Liquid Saturated steam($\leq 0.6\text{MPa}$)
Working Temperature: $-20^{\circ}\text{C} \leq t \leq 120^{\circ}\text{C}$
Parallel Pipe Thread to ISO228

DN	Size	A	B	C	D	G
15	1/2	45	11	65-71	54	1/2
20	3/4	50	11	70.5-78	60	3/4
25	1	64.5	15	82-91	72	1
32	1 1/4	75	16	95-106	80	1 1/4
40	1 1/2	82	17	109-121	100	1 1/2
50	2	100	19	122.5-136	110	2

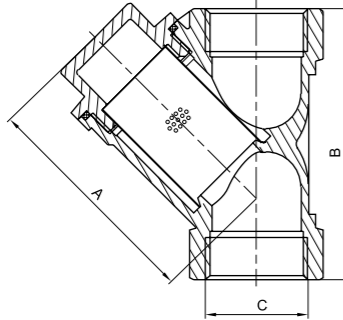

606 黄铜过滤器
Brass Strainer (SY11-16T)

技术规范
公称压力: 1.6 MPa
工作介质: 水
工作温度: $0^{\circ}\text{C} \leq t \leq 150^{\circ}\text{C}$
圆柱管螺纹符合ISO228标准

Technical Standard
Nominal Pressure: 1.6 Mpa
Working Medium: Water
Working Temperature: $0^{\circ}\text{C} \leq t \leq 150^{\circ}\text{C}$
Parallel Pipe Thread to ISO228

DN	Size	A	B	C	过滤网目数
15	1/2	48	55.5	1/2	24X24
20	3/4	59	70	3/4	24X24
25	1	69	82	1	24X24
32	1 1/4	81	90	1 1/4	12X9
40	1 1/2	88	101	1 1/2	12X9
50	2	107	123.5	2	12X9
65	2 1/2	149.4	172	2 1/2	12X9

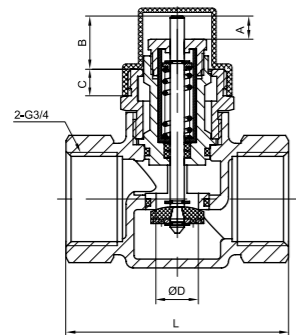

768 电动阀
Motorized Valve (J911X-16T)

技术规范
公称压力: 2.0 MPa
工作介质: 水
密封压差: DN20: 0.3MPa
DN25: 0.1MPa
工作温度: $1^{\circ}\text{C} \leq t \leq 95^{\circ}\text{C}$
圆柱管螺纹符合ISO228标准

Technical Standard
Nominal Pressure: 2.0 Mpa
Working Medium: Water
Sealing Pressure Difference: DN20: 0.3MPa
DN25: 0.1MPa
Working Temperature: $1^{\circ}\text{C} \leq t \leq 95^{\circ}\text{C}$
Parallel Pipe Thread to ISO228

DN	Size	A	B	C	D	I	G
20	3/4	7	15	7.5	12	63	3/4
25	1	7	15	7.5	16.5	73	1

620/622 电动球阀
Motorized Ball Valve

特点

- 球阀电机采用由双向同步电机驱动, 顺、逆时针旋转 90° , 可有效防止球阀被管道污物卡阻;
- 球阀采用全通径设计, 减少产品压损, 保证管道流量及压力
- 驱动器之平面设计可以贴近墙面安装, 占用空间小。产品可靠耐用, 工作噪音低

技术参数

规格	通径	联接螺纹	工作介质	流体温度	环境温度	公称压力	电气规格
DN20	15	G3/4"	冷冻水/热水	0-94°C	0-40°C	2.5 MPa	24V
DN25	20	G1"					110V
DN32	25	G1 1/4"					220V
							50/60HZ



620



622



667 不锈钢波纹管 (加强型)
Stainless Steel Waving Hose (Strengthen)

669 不锈钢半波纹管
Stainless Semi-Wave Hose

669A 不锈钢半波纹管
Stainless Semi-Wave Hose



668 不锈钢全波纹管
Stainless Full-Wave Hose

668A 不锈钢全波纹管
Stainless Full-Wave Hose

261 黄铜过滤球阀
Brass Filter Ball Valve (Q11F-16T)



768 电动两通阀
Motorized Valve



645 液晶采暖温控器
LCD Air-conditioning Thermostat



644 机械采暖温控器
Mechanical Air-conditioning Thermostat



646 触控采暖温控器
Air-conditioning Thermostat With Touch Screen

水司系列 WATER COMPANY SERIES



水司推荐

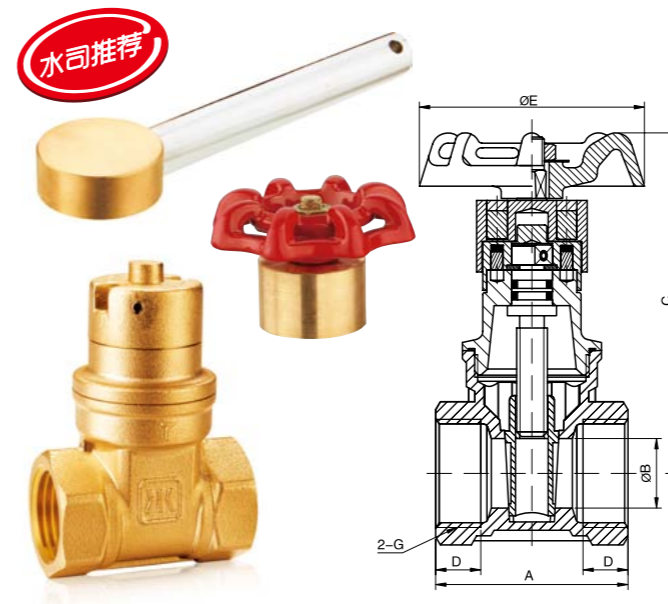

9119 黄铜磁性锁式闸阀 Brass Magnetic Lockable Gate Valve (Z15W-16T)

技术规范	Technical Standard
公称压力: 1.6 MPa	Nominal Pressure: 1.6 Mpa
工作介质: 水、非腐蚀性液体、饱和蒸汽(≤0.6MPa)	Working Medium: Water, Non-causticity liquid, Saturated steam(≤0.6MPa)
工作温度: -10℃≤t≤110℃	Working Temperature: -10℃≤t≤110℃
圆柱管螺纹符合ISO228标准	Parallel Pipe Thread to ISO228

手轮	DN	A	B	C	D	E	G
	15	43.5	13	75.5	10.5	54	1/2
	20	47	17	83.2	11	54	3/4
	25	52	21	90.2	13	54	1

长手柄锁	DN	A	B	C	D	G
	32	57	27	77.5	13.5	1 1/4
	40	60	34	90.3	14	1 1/2
	50	67	45	108.8	15	2

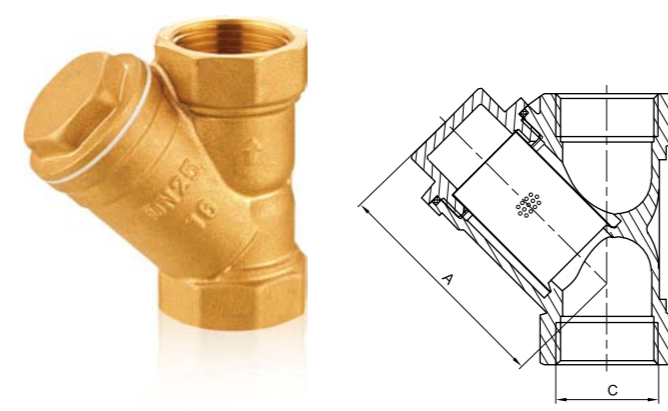

606 黄铜过滤器 Brass Strainer (SY11-16T)

技术规范	Technical Standard
公称压力: 1.6 MPa	Nominal Pressure: 1.6 Mpa
工作介质: 水	Working Medium: Water
工作温度: 0℃≤t≤150℃	Working Temperature: 0℃≤t≤150℃
圆柱管螺纹符合ISO228标准	Parallel Pipe Thread to ISO228

DN	Size	A	B	C	过滤网目数
15	1/2	48	55.5	1/2	24X24
20	3/4	59	70	3/4	24X24
25	1	69	82	1	24X24
32	1 1/4	81	90	1 1/4	12X9
40	1 1/2	88	101	1 1/2	12X9
50	2	107	123.5	2	12X9
65	2 1/2	149.4	172	2 1/2	12X9

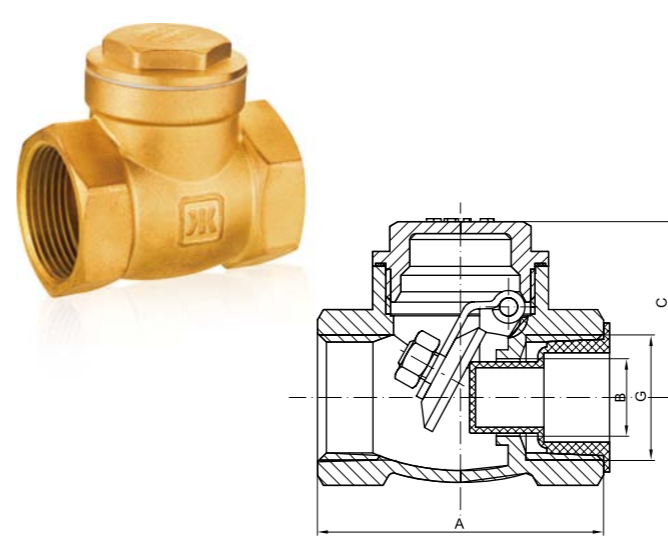

408 黄铜止回阀 Brass Check Valve (H14W-16T)

技术规范	Technical Standard
公称压力: 1.6 MPa	Nominal Pressure: 1.6 Mpa
工作介质: 水、非腐蚀性液体	Working Medium: Water, Non-causticity Liquid
工作温度: ≤100℃	Working Temperature: ≤100℃
圆柱管螺纹符合ISO228标准	Parallel Pipe Thread to ISO228

DN	Size	A	B	C	G
15	1/2	48	13	29.5	1/2
20	3/4	57	17	35.5	3/4
25	1	68	23	42	1
32	1 1/4	74	28	48.5	1 1/4
40	1 1/2	82	33	53	1 1/2
50	2	92.5	44	59	2
65	2 1/2	130	63	85.5	2 1/2
80	3	147	75	95.5	3
100	4	180	93	116.5	4

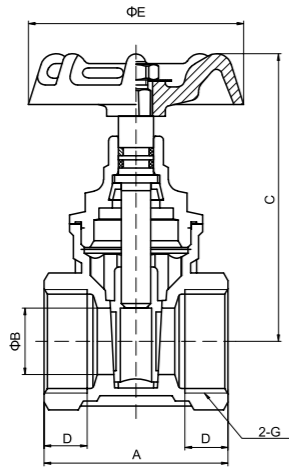

169 黄铜闸阀
Brass Gate Valve (Z15W-16T)

技术规范 公称压力: 1.6 MPa
工作介质: 水、非腐蚀性液体
工作温度: $-20^{\circ}\text{C} \leq t \leq 110^{\circ}\text{C}$
圆柱管螺纹符合ISO228标准

Technical Standard Nominal Pressure: 1.6 Mpa
Working Medium: Water, Non-causticity liquid
Working Temperature: $-20^{\circ}\text{C} \leq t \leq 110^{\circ}\text{C}$
Parallel Pipe Thread to ISO228

DN	A	B	C	D	E	G
15	43.5	13	68.4	10.5	54	1/2
20	47	17	73.5	11	54	3/4
25	52	21	83	13	60	1
32	57	27	98	13.5	72	1 1/4
40	60	34	111	14	72	1 1/2
50	69	45	132	15	80	2

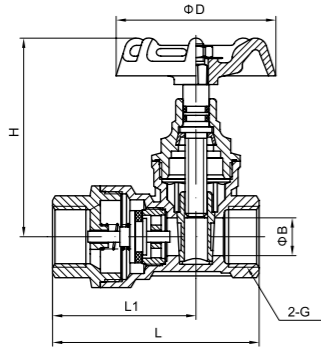

9169 黄铜带止回锁式闸阀
Brass Lockable Gate Valve With Non-Return Function (Z15W-16T)

技术规范 公称压力: 1.6 MPa
工作介质: 水
工作温度: $0^{\circ}\text{C} \leq t \leq 90^{\circ}\text{C}$
圆柱管螺纹符合ISO228-1标准

Technical Standard Nominal Pressure: 1.6 Mpa
Working Medium: Water
Working Temperature: $0^{\circ}\text{C} \leq t \leq 90^{\circ}\text{C}$
Parallel Pipe Thread to ISO228-1

DN	L	L1	B	G	D	H
15	71	49.5	13	G1/2	54	68.5
20	79.7	56.2	17	G3/4	54	73.5

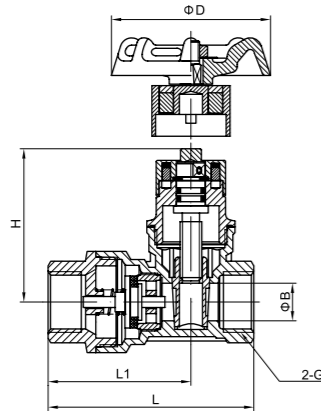

9168 黄铜带止回闸阀
Brass Lockable Gate Valve (Z15W-16T)

技术规范 公称压力: 1.6 MPa
工作介质: 水
工作温度: $0^{\circ}\text{C} \leq t \leq 90^{\circ}\text{C}$
圆柱管螺纹符合ISO228-1标准

Technical Standard Nominal Pressure: 1.6 Mpa
Working Medium: Water
Working Temperature: $0^{\circ}\text{C} \leq t \leq 90^{\circ}\text{C}$
Parallel Pipe Thread to ISO228-1

DN	L	L1	B	G	D	H
15	71	49.5	13	G1/2	54	53
20	79.7	56.2	17	G3/4	54	60.7

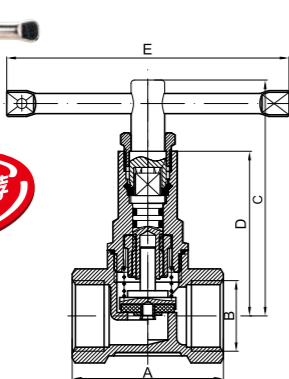

316 黄铜锁式止回截止阀
Brass Stop Valve (J11W-16T)

技术规范 公称压力: 1.6 MPa
工作介质: 水、非腐蚀性液体
工作温度: $-20^{\circ}\text{C} \leq t \leq 120^{\circ}\text{C}$
圆柱管螺纹符合ISO228标准

Technical Standard Nominal Pressure: 1.6 Mpa
Working Medium: Water, Non-causticity Liquid
Working Temperature: $-20^{\circ}\text{C} \leq t \leq 120^{\circ}\text{C}$
Parallel Pipe Thread to ISO228

DN	Size	A	B	C	D	E
15	1/2	45	2-G1/2	70	49	84
20	3/4	51	2-G3/4	89.5	51	84
25	1	64.5	2-G1	108.3	79.3	160
32	1 1/4	75	2-G1 1/4	119.8	90.8	160
40	1 1/2	82	2-G1 1/2	135	72	160
50	2	100	2-G2	110	77	160

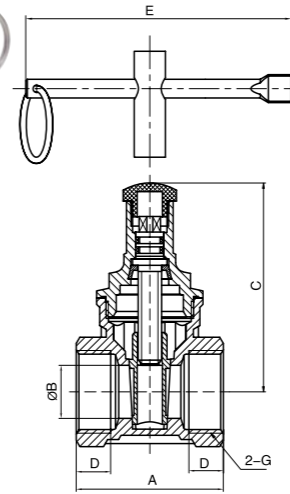

9118 黄铜锁式闸阀
Brass Lockable Gate Valve (Z15W-16T)

技术规范 公称压力: 1.6 MPa
工作介质: 水、非腐蚀性液体
工作温度: $-10^{\circ}\text{C} \leq t \leq 110^{\circ}\text{C}$
圆柱管螺纹符合ISO228标准

Technical Standard Nominal Pressure: 1.6 Mpa
Working Medium: Water, Non-causticity liquid
Working Temperature: $-10^{\circ}\text{C} \leq t \leq 110^{\circ}\text{C}$
Parallel Pipe Thread to ISO228

DN	A	B	C	D	E	G
15	43.5	13	62.3	10.5	75	1/2
20	47	17	66.8	11	75	3/4
25	52	21	75	13	75	1
32	57	27	87	13.5	75	1 1/4
40	60	34	98	14	120	1 1/2
50	67	45	115.6	15	120	2

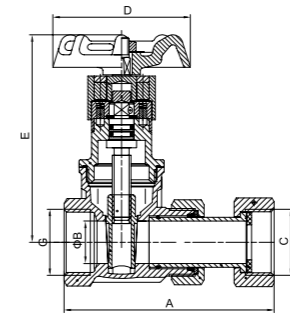

114 黄铜表前磁性闸阀
Brass Magnetic Gate Valve Before Water Meter (Z15W-16T)

技术规范 公称压力: 1.6 MPa
工作介质: 水、非腐蚀性液体
适用温度: $t \leq 150^{\circ}\text{C}$
圆柱管螺纹符合ISO228-1: 2000标准

Technical Standard Nominal Pressure: 1.6 Mpa
Working Medium: Water, Non-causticity liquid
Working Temperature: $t \leq 150^{\circ}\text{C}$
Parallel Pipe Thread to ISO228-1:2000

DN	A	B	C	D	E	G
15X20	96.5-108.5	13	G3/4	54	75.5	G1/2
20X20	84-96	17.5	G3/4	54	83	G3/4
20X25	84.5-96.5	17.5	G1	54	83	G3/4
25X25	102-115.5	21	G1	54	90	G1

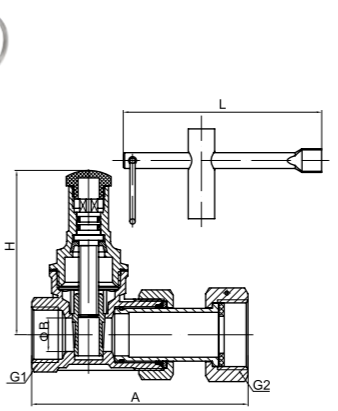

189 黄铜锁式伸缩闸阀
Brass Lockable Gate Valve With Expansion Joint (Z15W-16T)

技术规范 公称压力: 1.6 MPa
工作介质: 水、非腐蚀性液体
适用温度: $-10^{\circ}\text{C} \leq t \leq 100^{\circ}\text{C}$
圆柱管螺纹符合ISO228-1

Technical Standard Nominal Pressure: 1.6 Mpa
Working Medium: Water, Non-causticity liquid
Working Temperature: $-10^{\circ}\text{C} \leq t \leq 100^{\circ}\text{C}$
Parallel Pipe Thread to ISO228-1

DN	L	A	B	G1	G2	H
15x20	75	82-94	12.7	G1/2	G3/4	62
20x20	75	84-96	17.5	G3/4	G3/4	67
20x25	75	84.5-96.5	17.5	G3/4	G1	67

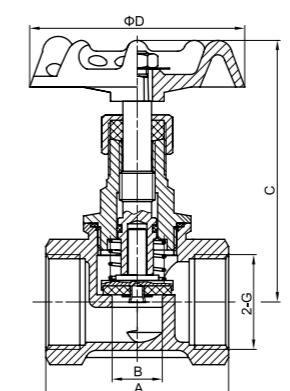

385 黄铜止回截止阀
Brass Check Stop Valve (J12W-16T)

技术规范 公称压力: 1.6 MPa
工作介质: 水、非腐蚀性液体
工作温度: $-20^{\circ}\text{C} \leq t \leq 120^{\circ}\text{C}$
圆柱管螺纹符合ISO228标准

Technical Standard Nominal Pressure: 1.6 Mpa
Working Medium: Water, Non-causticity Liquid
Working Temperature: $-20^{\circ}\text{C} \leq t \leq 120^{\circ}\text{C}$
Parallel Pipe Thread to ISO228

DN	Size	A	B	C	D	G
15	1/2	45	12	66-72	54	1/2
20	3/4	51	16	73-79	60	3/4
25	1	64.5	22	82-90	72	1
32	1 1/4	75	26	95-104	80	1 1/4
40	1 1/2	82	32	112-125	80	1 1/2
50	2	100	41	124.5-137.5	100	2

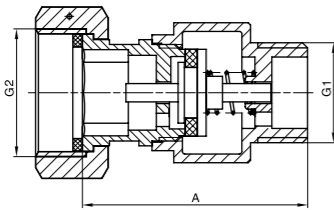

406 黄铜表后控制阀
Brass Control Valve (H32X-16T)

技术规范
公称压力: 1.6 MPa
工作介质: 水
工作温度: 0°C ≤ t ≤ 90°C
圆柱管螺纹符合ISO228标准

Technical Standard
Nominal Pressure: 1.6 Mpa
Working Medium: Water
Working Temperature: 0°C ≤ t ≤ 90°C
Parallel Pipe Thread to ISO228

DN	A	G1	G2
15	46.6	1/2	3/4
20	52	3/4	1
25	55.5	1	1 1/4

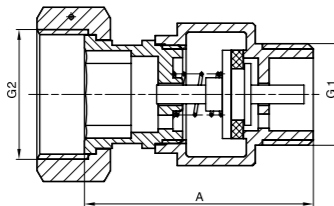

403 黄铜表前控制阀
Brass Control Valve (H32X-16T)

技术规范
公称压力: 1.6 MPa
工作介质: 水
工作温度: 0°C ≤ t ≤ 90°C
圆柱管螺纹符合ISO228标准

Technical Standard
Nominal Pressure: 1.6 Mpa
Working Medium: Water
Working Temperature: 0°C ≤ t ≤ 90°C
Parallel Pipe Thread to ISO228

DN	A	G1	G2
15	46.6	1/2	3/4
20	52	3/4	1

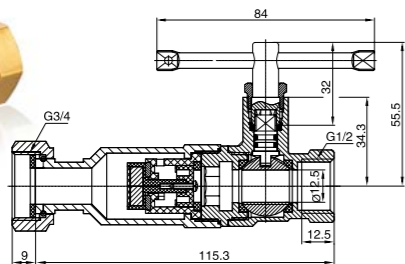

新品推荐

278 黄铜表前锁式止回阀
Brass Lockable Check Valve Before Water Meter (Q11F-16T)

技术规范
公称压力: 1.6 MPa
工作介质: 水
工作温度: t ≤ 80°C
圆柱管螺纹符合ISO228标准

Technical Standard
Nominal Pressure: 1.6 Mpa
Working Medium: Water
Working Temperature: t ≤ 80°C
Parallel Pipe Thread to ISO228

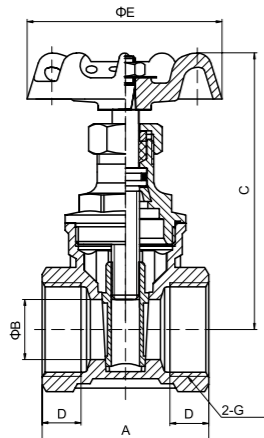

9105 黄铜闸阀
Brass Gate Valve (Z15W-16T)

技术规范
公称压力: 1.6 MPa
工作介质: 水、非腐蚀性液体、饱和蒸汽(≤0.6MPa)
工作温度: -20°C ≤ t ≤ 150°C
圆柱管螺纹符合ISO228标准

Technical Standard
Nominal Pressure: 1.6 Mpa
Working Medium: Water, Non-causticity liquid, Saturated steam(≤0.6MPa)
Working Temperature: -20°C ≤ t ≤ 150°C
Parallel Pipe Thread to ISO228

DN	A	B	C	D	E	G
15	43.5	13	72.5	10.5	54	1/2
20	47	17	78	11	54	3/4
25	52	21	91.5	13	60	1
32	57	27	105	13.5	72	1 1/4
40	60	34	117	14	72	1 1/2
50	69	45	143	16	80	2



水司推荐

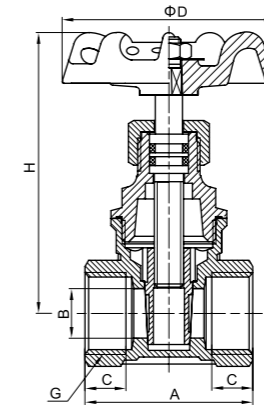

121 黄铜抽杆式闸阀
Brass Pumped Leveraged Gate Valve (Z15W-16T)

技术规范
公称压力: 1.6 MPa
工作介质: 水、非腐蚀性液体
工作温度: -10°C ≤ t ≤ 110°C
圆柱管螺纹符合ISO228标准

Technical Standard
Nominal Pressure: 1.6 Mpa
Working Medium: Water, Non-causticity liquid
Working Temperature: -10°C ≤ t ≤ 110°C
Parallel Pipe Thread to ISO228

DN	A	B	C	D	H	G
15	43	12.7	10.5	54	72	1/2
20	46	16	11	54	78	3/4
25	49	20	12	60	84	1
32	52	26	12.5	68	100	1 1/4
40	56.5	32	13	72	108	1 1/2
50	64	43	14.5	80	132	2
80	83	63.5	19	110	180	3
100	101.5	84	25	126	218	4



水司推荐

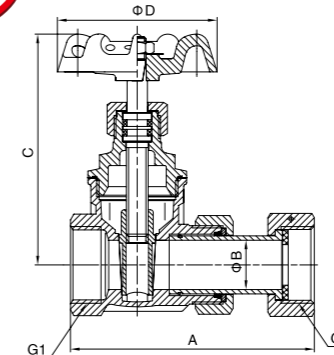

109 黄铜水表闸阀
Brass Water Meter Gate Valve (Z15W-16T)

技术规范
公称压力: 1.6 MPa
工作介质: 水、非腐蚀性液体
工作温度: -10°C ≤ t ≤ 110°C
圆柱管螺纹符合ISO228标准

Technical Standard
Nominal Pressure: 1.6 Mpa
Working Medium: Water, Non-causticity liquid
Working Temperature: -10°C ≤ t ≤ 110°C
Parallel Pipe Thread to ISO228

DN	A	B	C	D	G1	G2
20	84-96	17	79	54	3/4	3/4
20	84.5-96.5	17	77	54	3/4	1

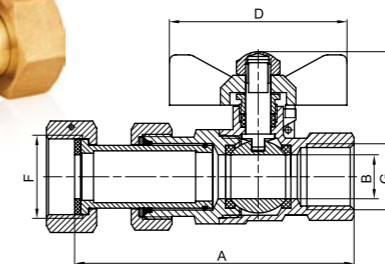

229 黄铜水表球阀
Brass Water Meter Ball Valve (Q11F-16T)

技术规范
公称压力: 1.6 MPa
工作介质: 水、非腐蚀性液体
工作温度: -10°C ≤ t ≤ 100°C
圆柱管螺纹符合ISO228标准

Technical Standard
Nominal Pressure: 1.6 Mpa
Working Medium: Water, Non-causticity liquid
Working Temperature: -10°C ≤ t ≤ 100°C
Parallel Pipe Thread to ISO228

DN	Size	A	B	C	D	F	G
15	1/2	89-103	14	41	56.5	3/4	1/2
20	3/4	94-106	15	42.9	56.5	1	3/4

315 黄铜异径截止阀
Brass Reduced Stop Valve (J11F-16T)

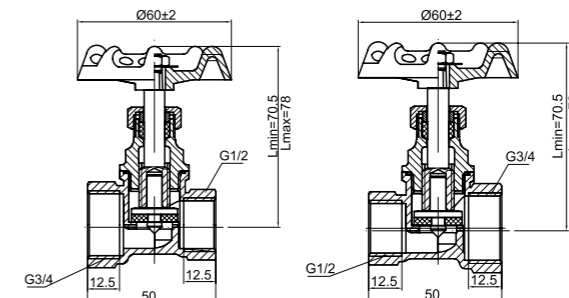

技术规范
公称压力: 1.6 MPa
工作介质: 水、非腐蚀性液体
工作温度: -20°C ≤ t ≤ 120°C
圆柱管螺纹符合ISO228标准

Technical Standard
Nominal Pressure: 1.6 Mpa
Working Medium: Water, Non-causticity liquid
Working Temperature: -20°C ≤ t ≤ 120°C
Parallel Pipe Thread to ISO228

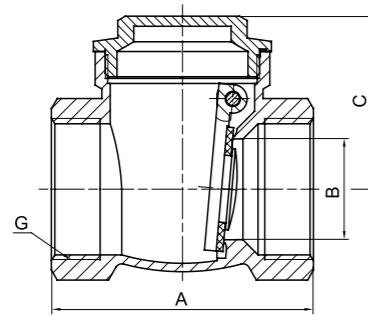

404 黄铜止回阀
Brass Check Valve (H14X-16T)

技术规范

公称压力: 1.6 MPa
工作介质: 水、非腐蚀性液体
工作温度: $\leq 100^{\circ}\text{C}$
圆柱管螺纹符合ISO228标准

Technical Standard

Nominal Pressure: 1.6 MPa
Working Medium: Water, Non-causticity Liquid
Working Temperature: $\leq 100^{\circ}\text{C}$
Parallel Pipe Thread to ISO228

DN	Size	A	B	C	G
15	1/2	48	13	34	1/2
20	3/4	59	17	40.5	3/4
25	1	68	23	46	1
32	1 1/4	78	30	51.5	1 1/4
40	1 1/2	88	35	57.5	1 1/2
50	2	105	45	68.5	2
65	2 1/2	130	63	85.5	2 1/2
80	3	147	75	95.5	3
100	4	180	93	116.5	4

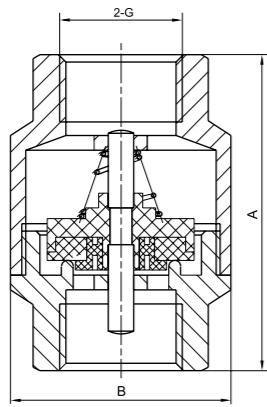

405 黄铜立式止回阀
Brass Vertical Check Valve (H12X-10T)

技术规范

公称压力: 1.0 MPa
工作介质: 水、非腐蚀性液体、饱和蒸汽($\leq 0.6\text{MPa}$)
工作温度: $-20^{\circ}\text{C} \leq t \leq 80^{\circ}\text{C}$
圆柱管螺纹符合ISO228标准

Technical Standard

Nominal Pressure: 1.0 MPa
Working Medium: Water, Non-causticity Liquid, Saturated steam($\leq 0.6\text{MPa}$)
Working Temperature: $-20^{\circ}\text{C} \leq t \leq 80^{\circ}\text{C}$
Parallel Pipe Thread to ISO228

DN	Size	A	B	G
10	3/8	43	30	3/8
15	1/2	49.5	35	1/2
20	3/4	53.5	41	3/4
25	1	60	49	1
32	1 1/4	70	58	1 1/4
40	1 1/2	77.5	67.5	1 1/2
50	2	84.5	83	2

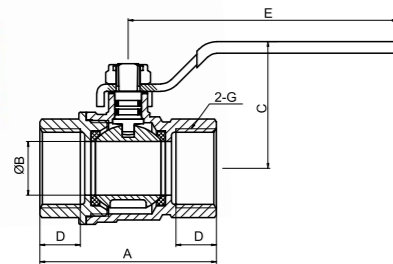

9266 黄铜球阀
Brass Ball Valve (Q11F-16T)

技术规范

公称压力: 1.6 MPa
工作介质: 水、非腐蚀性液体
工作温度: $-10^{\circ}\text{C} \leq t \leq 100^{\circ}\text{C}$
圆柱管螺纹符合ISO228标准

Technical Standard

Nominal Pressure: 1.6 MPa
Working Medium: Water, Non-causticity liquid
Working Temperature: $-10^{\circ}\text{C} \leq t \leq 100^{\circ}\text{C}$
Parallel Pipe Thread to ISO228

DN	A	B	C	D	E	G
15	52	13	39.1	12.5	90	1/2
20	59	18	42.4	13.5	90	3/4
25	71	24	55.3	14.5	110	1
32	81	30	60.8	15.5	140.2	1 1/4
40	93.2	37	66.7	16.5	140.2	1 1/2
50	111	49.5	78.2	18.5	155.3	2

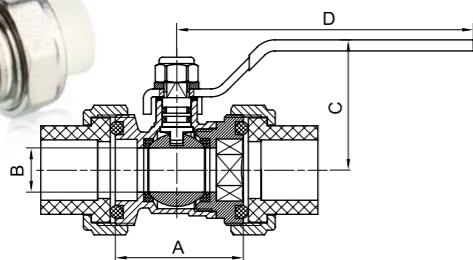

209 黄铜PPR球阀
Brass PPR Ball Valve (Q11F-16T)

技术规范

公称压力: 1.6 MPa
工作介质: 水、非腐蚀性液体
工作温度: $-10^{\circ}\text{C} \leq t \leq 120^{\circ}\text{C}$

Technical Standard

Nominal Pressure: 1.6 MPa
Working Medium: Water, Non-causticity liquid
Working Temperature: $-10^{\circ}\text{C} \leq t \leq 120^{\circ}\text{C}$

备注: 接头材质可选择PPR、PB、PERT

DN	Size	A	B	C	D
15	1/2	40.5	14	41.7	97.5
20	3/4	47	19	44.9	97.5
25	1	53	23.5	55.5	110
32	1 1/4	62	30	61	140
40	1 1/2	75.6	37	66	140
50	2	88	46.5	75	155

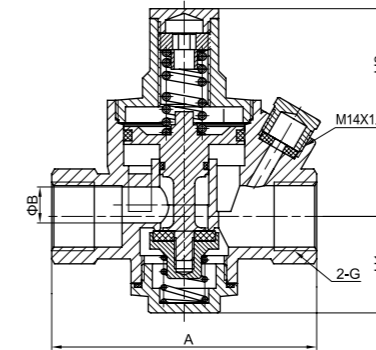

707 黄铜活塞式减压阀
Brass Piston Valve (Y13X-16T)

技术规范

公称压力: 1.6 MPa
工作介质: 水
工作温度: $0^{\circ}\text{C} \leq t \leq 80^{\circ}\text{C}$
出口压力: 0.1MPa-0.55MPa
圆柱管螺纹符合ISO228标准

Technical Standard

Nominal Pressure: 1.6 MPa
Working Medium: Water
Working Temperature: $0^{\circ}\text{C} \leq t \leq 80^{\circ}\text{C}$
Export Pressure: 0.1MPa-0.55MPa
Parallel Pipe Thread to ISO228

DN	Size	A	B	H1	H2	G
15	1/2	78	11	29.5	64	1/2
20	3/4	78.5	11	30	63.5	3/4
25	1	85	15	35.5	77	1
32	1 1/4	85	18	37	79	1 1/4
40	1 1/2	103	22.5	47.5	105	1 1/2
50	2	120	28.5	54.5	126.5	2

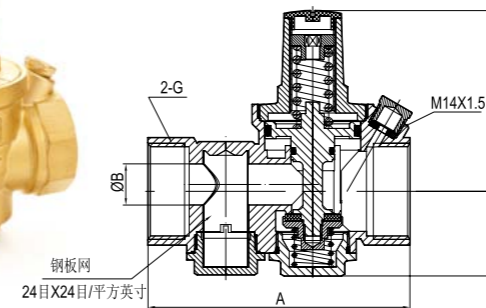

727 黄铜带过滤器减压阀
Brass Reducing Valve With Filter (Y13X-16T)

技术规范

公称压力: 1.6 MPa
工作介质: 水
工作温度: $0^{\circ}\text{C} \leq t \leq 80^{\circ}\text{C}$
出口压力: 0.1MPa-0.55MPa
圆柱管螺纹符合ISO228标准

Technical Standard

Nominal Pressure: 1.6 MPa
Working Medium: Water
Working Temperature: $0^{\circ}\text{C} \leq t \leq 80^{\circ}\text{C}$
Export Pressure: 0.1MPa-0.55MPa
Parallel Pipe Thread to ISO228

DN	Size	A	B	H1	H2	G
15	1/2	98.5	11	29.5	65	1/2
20	3/4	99	11	30	64.5	3/4
25	1	110.5	15	35.5	77	1
32	1 1/4	114.5	18	37	79	1 1/4
40	1 1/2	139	22.5	47.5	105	1 1/2
50	2	162	28.5	54.5	126.5	2

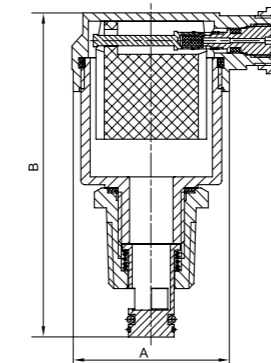

705 黄铜排气阀
Brass Exhausting Valve (P25X-16T)

技术规范

公称压力: 1.6 MPa
工作介质: 水
工作温度: $0^{\circ}\text{C} \leq t \leq 120^{\circ}\text{C}$
管螺纹符合ISO7标准

Technical Standard

Nominal Pressure: 1.6 MPa
Working Medium: Water
Working Temperature: $0^{\circ}\text{C} \leq t \leq 120^{\circ}\text{C}$
Taper Pipe Thread to ISO7

DN	A	B
15	38.5	78.5
20	38	77.5
25	38	77.5

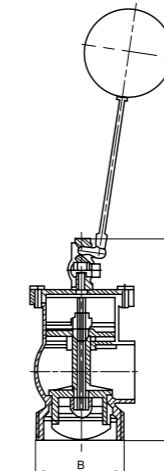

901 浮球阀
Floating Ball Actuated Valve (KXL-6T-A)

技术规范

公称压力: 0.04 MPa $\leq P \leq 0.6\text{MPa}$
工作介质: 水
工作温度: $0^{\circ}\text{C} \leq t \leq 80^{\circ}\text{C}$
联接方式: 管螺纹

Technical Standard

Nominal Pressure: 0.04 MPa $\leq P \leq 0.6\text{MPa}$
Working Medium: Water
Working Temperature: $0^{\circ}\text{C} \leq t \leq 80^{\circ}\text{C}$
Connecting From: Pipe Thread

DN	Size	A	B
15	1/2	80	50
20	3/4	120	35
25	1	125	43
32	1 1/4	145	52
40	1 1/2	155	57
50	2	168	69
65	2 1/2	200	88
80	3	225	100
100	4	250	127

燃气阀门系列 GAS VALVES SERIES



新品推荐

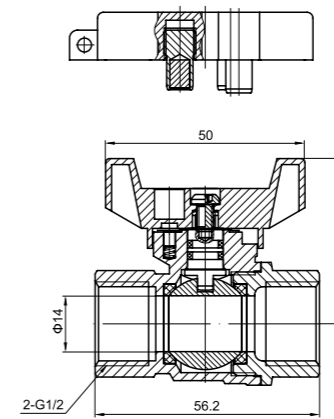

9200A 黄铜双控防盗燃气球阀
Brass Double Control Gas Ball Valve Antitheft (RQL-PN16)

技术规范

公称压力: 1.6 MPa
工作介质: 天然气、人工煤气、液化石油气
工作温度: $-20^{\circ}\text{C} \leq t \leq 110^{\circ}\text{C}$
圆柱管螺纹符合ISO228标准

Technical Standard

Nominal Pressure: 1.6 MPa
Working Medium: Natural gas, Artificial gas, Liquefied petroleum gas
Working Temperature: $-20^{\circ}\text{C} \leq t \leq 110^{\circ}\text{C}$
Parallel Pipe Thread to ISO228

9277A 黄铜磁控防盗球阀
Brass Magnetic Anti-Theft Ball Valve (RQL-PN16)

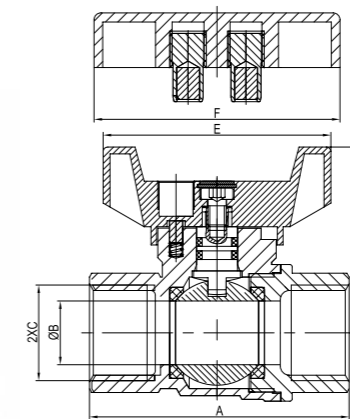

产品特点:

1. 主要零件采用优质铜材 (HPb59-1) 和热锻工艺制作而成, 使产品具有良好的机械物理性能。
2. 采用优质氟塑料 (PTFE) 作为密封材料, 保证产品无泄漏, 并有较高的使用寿命。
3. 当处于管理模式状态下, 用户无法开关燃气阀, 只有燃气公司通过专用钥匙才能开关燃气阀, 真正实现有效管控。

技术规范

公称压力: 1.6 MPa
工作介质: 天然气、人工煤气、液化石油气
工作温度: $-20^{\circ}\text{C} \leq t \leq 110^{\circ}\text{C}$
圆柱管螺纹符合ISO228标准

Technical Standard

Nominal Pressure: 1.6 MPa
Working Medium: Natural gas, Artificial gas, Liquefied petroleum gas
Working Temperature: $-20^{\circ}\text{C} \leq t \leq 110^{\circ}\text{C}$
Parallel Pipe Thread to ISO228

DN	A	B	C	D	E	F
15	57	14	G1/2	41	50	54
20	67	19	G3/4	44	50	54
25	78.6	24	G1	50	50	54

- ★ 产品设计按CJ/T180-2014设计
- ★ 全通径系列, 长度符合N4要求。

新品推荐

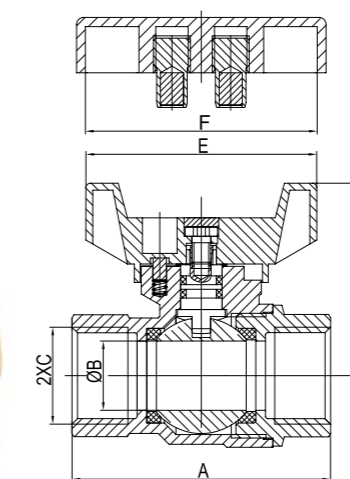

R50201 黄铜磁控防盗球阀
Brass Magnetic Anti-Theft Ball Valve (RQL-PN16)

技术规范

公称压力: 1.6 MPa
工作介质: 天然气、人工煤气、液化石油气
工作温度: $-20^{\circ}\text{C} \leq t \leq 110^{\circ}\text{C}$
圆柱管螺纹符合ISO228标准

Technical Standard

Nominal Pressure: 1.6 MPa
Working Medium: Natural Gas, Artificial Gas, Liquefied Petroleum Gas
Working Temperature: $-20^{\circ}\text{C} \leq t \leq 110^{\circ}\text{C}$
Parallel Pipe Thread to ISO228

DN	A	B	C	D	E	F
15	56	14	G1/2	42	50	54
20	67	19	G3/4	47	50	54

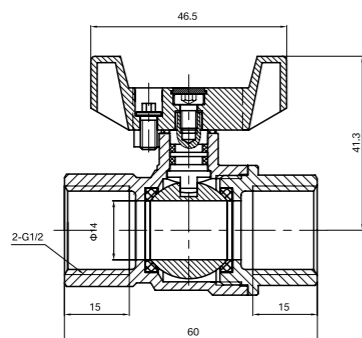

9241 黄铜可控防盗燃气球阀
Brass Gas Ball Valve Controlled Anti-theft (RQL-PN16)

产品特点:

1. 主要零件采用优质铜材 (HPb59-1) 和热锻工艺制作而成, 使产品具有良好的机械物理性能。
2. 采用优质氟塑料 (PTFE) 作为密封材料, 保证产品无泄漏, 并有较高的使用寿命。
3. 当处于管理模式状态时, 使用专用钥匙将非标螺钉拆卸, 即可自由开关燃气阀。

技术规范

公称压力: 1.6 MPa
工作介质: 天然气、人工煤气、液化石油气
工作温度: $-20^{\circ}\text{C} \leq t \leq 110^{\circ}\text{C}$
圆柱管螺纹符合ISO228标准

Technical Standard

Nominal Pressure: 1.6 Mpa
Working Medium: Natural Gas,Artificial Gas, Liquefied Petroleum Gas
Working Temperature: $-20^{\circ}\text{C} \leq t \leq 110^{\circ}\text{C}$
Parallel Pipe Thread to ISO228

新品推荐

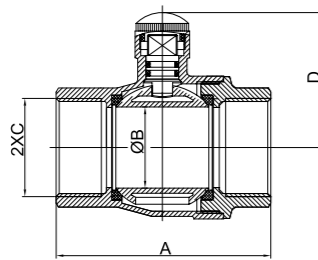

★ 内藏式防拆结构, 需专用工具来开启关闭。

R50001 黄铜内螺纹锁式球阀
Lockable Gas Ball Valve FF (RQL-PN16)

技术规范

公称压力: 1.6 MPa
工作介质: 天然气、人工煤气、液化石油气
工作温度: $-20^{\circ}\text{C} \leq t \leq 110^{\circ}\text{C}$
圆柱管螺纹符合ISO228标准

Technical Standard

Nominal Pressure: 1.6 Mpa
Working Medium: Natural Gas,Artificial Gas, Liquefied Petroleum Gas
Working Temperature: $-20^{\circ}\text{C} \leq t \leq 110^{\circ}\text{C}$
Parallel Pipe Thread to ISO228

DN	A	B	C	D
40	104.5	38	1 1/2	66
50	120	49	2	75.5

新品推荐

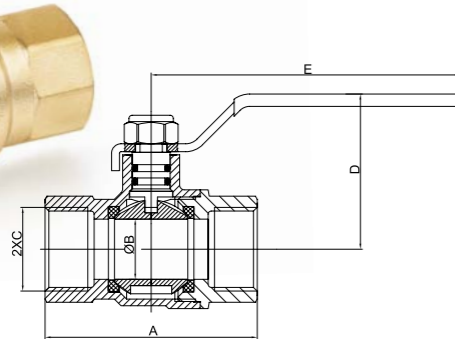
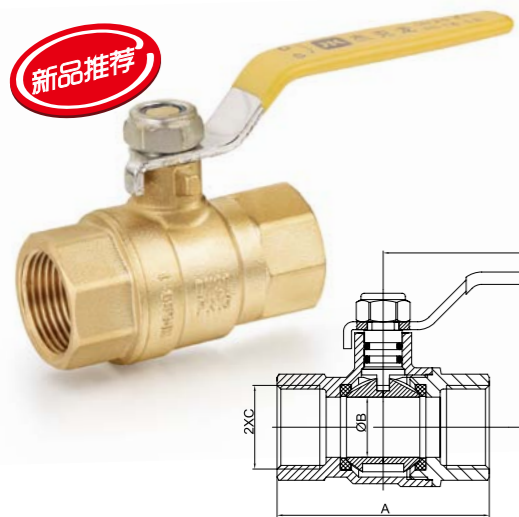

★ 产品设计按CJ/T180-2014设计
★ 全通径系列, 长度符合N4要求。

R60001 黄铜内螺纹球阀
Gas Ball Valve FF (RQL-PN16)

技术规范

公称压力: 1.6 MPa
工作介质: 天然气、人工煤气、液化石油气
工作温度: $-20^{\circ}\text{C} \leq t \leq 110^{\circ}\text{C}$
圆柱管螺纹符合ISO228标准

Technical Standard

Nominal Pressure: 1.6 Mpa
Working Medium: Natural Gas,Artificial Gas, Liquefied Petroleum Gas
Working Temperature: $-20^{\circ}\text{C} \leq t \leq 110^{\circ}\text{C}$
Parallel Pipe Thread to ISO228

DN	A	B	C	D	E
15	56	15	G1/2	42	98
20	67	19	G3/4	49	97.7
25	78	24	G1	55	110
32	88	30	G1 1/4	63	140
40	104.5	38	G1 1/2	68	140
50	120	49	G2	79	156

新品推荐

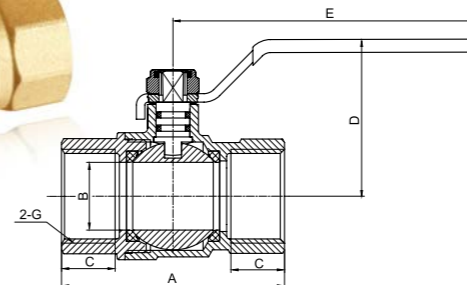

★ 产品设计按JB/T 11492-2013设计, 长度符合N4标准。

9239 黄铜燃气球阀
Brass Gas Ball Valve (RQL-PN16)

技术规范

公称压力: 1.6 MPa
工作介质: 天然气、人工煤气、液化石油气
工作温度: $-20^{\circ}\text{C} \leq t \leq 110^{\circ}\text{C}$
圆柱管螺纹符合ISO228标准

Technical Standard

Nominal Pressure: 1.6 Mpa
Working Medium: Natural Gas,Artificial Gas, Liquefied Petroleum Gas
Working Temperature: $-20^{\circ}\text{C} \leq t \leq 110^{\circ}\text{C}$
Parallel Pipe Thread to ISO228

DN	Size	A	B	C	D	E
15	1/2	56.2	12.7	12.5	40.7	97.7
20	3/4	68	18	16.8	43.9	97.7
25	1	79	24	19	55.4	110
32	1 1/4	89.1	30	18.5	62	140
40	1 1/2	105.5	32	22	62.9	140
50	2	120.5	40	26.5	72	155

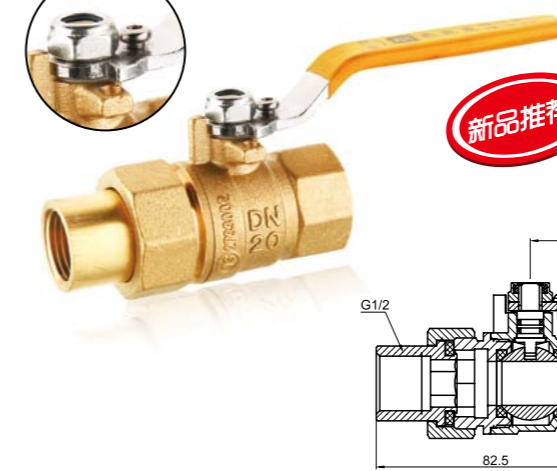

新品推荐

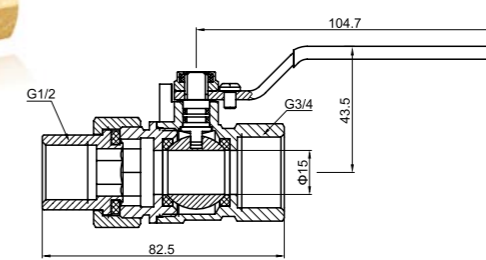

9286 黄铜防拆式活接球阀
Brass Anti-Tamper Gas Ball Valve
Compression Ends(RQH-PN16)

技术规范

公称压力: 1.6 MPa
工作介质: 天然气、人工煤气、液化石油气
工作温度: $-20^{\circ}\text{C} \leq t \leq 110^{\circ}\text{C}$
圆柱管螺纹符合ISO228标准

Technical Standard

Nominal Pressure: 1.6 Mpa
Working Medium: Natural Gas,Artificial Gas, Liquefied Petroleum Gas
Working Temperature: $-20^{\circ}\text{C} \leq t \leq 110^{\circ}\text{C}$
Parallel Pipe Thread to ISO228

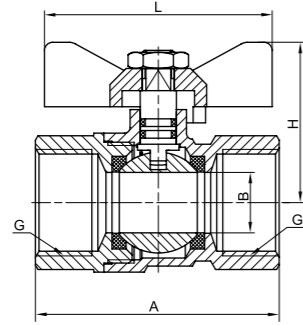

239A 黄铜燃气球阀
Brass Gas Ball Valve (RQL-PN16)

技术规范

公称压力: 1.6 MPa
工作介质: 天然气、人工煤气、液化石油气
工作温度: $-20^{\circ}\text{C} \leq t \leq 110^{\circ}\text{C}$
圆柱管螺纹符合ISO228标准

Technical Standard

Nominal Pressure: 1.6 Mpa
Working Medium: Natural Gas, Artificial Gas, Liquefied Petroleum Gas
Working Temperature: $-20^{\circ}\text{C} \leq t \leq 110^{\circ}\text{C}$
Parallel Pipe Thread to ISO228

DN	A	B	H	L	G
15	55.7	12.5	38.5	56.5	1/2
20	60.5	15	40	56.5	3/4
25	71	20	50	65	1

- ★ 产品设计按CJ/T180-2014设计
- ★ 全通路系列, 长度符合N9要求。

246 黄铜燃气球阀
Brass Gas Ball Valve (RQL-PN16)

技术规范

公称压力: 1.6 MPa
工作介质: 天然气、人工煤气、液化石油气
工作温度: $-20^{\circ}\text{C} \leq t \leq 110^{\circ}\text{C}$
圆柱管螺纹符合ISO228标准

Technical Standard

Nominal Pressure: 1.6 Mpa
Working Medium: Natural Gas, Artificial Gas, Liquefied Petroleum Gas
Working Temperature: $-20^{\circ}\text{C} \leq t \leq 110^{\circ}\text{C}$
Parallel Pipe Thread to ISO228

DN	A	B	C	D	E
15	68	15	G1/2	42	98
20	78	19.6	G3/4	49	97.7
25	86	24	G1	55	110
32	100	31.6	G1 1/4	62	140
40	106	39.5	G1 1/2	68	140
50	130	49	G2	77	155

246A 黄铜燃气球阀
Brass Gas Ball Valve (RQL-PN16)

技术规范

公称压力: 1.6 MPa
工作介质: 天然气、人工煤气、液化石油气
工作温度: $-20^{\circ}\text{C} \leq t \leq 110^{\circ}\text{C}$
圆柱管螺纹符合ISO228标准

Technical Standard

Nominal Pressure: 1.6 Mpa
Working Medium: Natural Gas, Artificial Gas, Liquefied Petroleum Gas
Working Temperature: $-20^{\circ}\text{C} \leq t \leq 110^{\circ}\text{C}$
Parallel Pipe Thread to ISO228

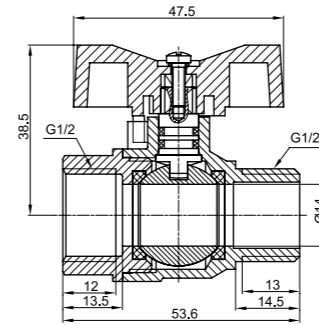
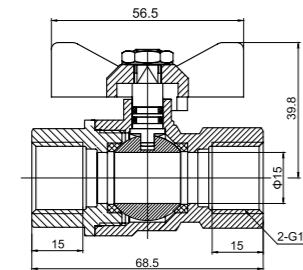

248 黄铜内外螺纹燃气球阀
Brass Gas Ball Valve MF (RQL-PN16)

技术规范

公称压力: 1.6 MPa
工作介质: 天然气、人工煤气、液化石油气
工作温度: $-20^{\circ}\text{C} \leq t \leq 110^{\circ}\text{C}$
圆柱管螺纹符合ISO228标准

Technical Standard

Nominal Pressure: 1.6 Mpa
Working Medium: Natural Gas, Artificial Gas, Liquefied Petroleum Gas
Working Temperature: $-20^{\circ}\text{C} \leq t \leq 110^{\circ}\text{C}$
Parallel Pipe Thread to ISO228

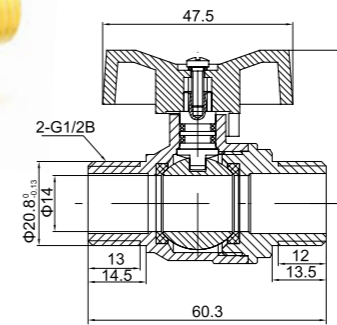

243 黄铜外螺纹燃气球阀
Brass Male Gas Ball Valve (RQL-PN16)

技术规范

公称压力: 1.6 MPa
工作介质: 天然气、人工煤气、液化石油气
工作温度: $-20^{\circ}\text{C} \leq t \leq 110^{\circ}\text{C}$
圆柱管螺纹符合ISO228标准

Technical Standard

Nominal Pressure: 1.6 Mpa
Working Medium: Natural Gas, Artificial Gas, Liquefied Petroleum Gas
Working Temperature: $-20^{\circ}\text{C} \leq t \leq 110^{\circ}\text{C}$
Parallel Pipe Thread to ISO228

207 黄铜内外丝燃气球阀
Brass Gas Ball Valve MF (RQZ-PN0.15)

技术规范

公称压力: 0.015 MPa
工作介质: 天然气、人工煤气、液化石油气
工作温度: $-20^{\circ}\text{C} \leq t \leq 110^{\circ}\text{C}$
圆柱管螺纹符合ISO228标准

Technical Standard

Nominal Pressure: 0.015 MPa
Working Medium: Natural Gas, Artificial Gas, Liquefied Petroleum Gas
Working Temperature: $-20^{\circ}\text{C} \leq t \leq 110^{\circ}\text{C}$
Parallel Pipe Thread to ISO228

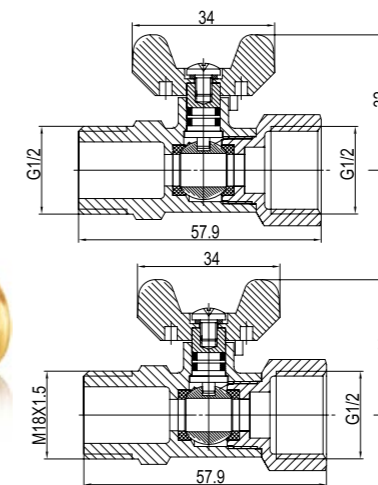

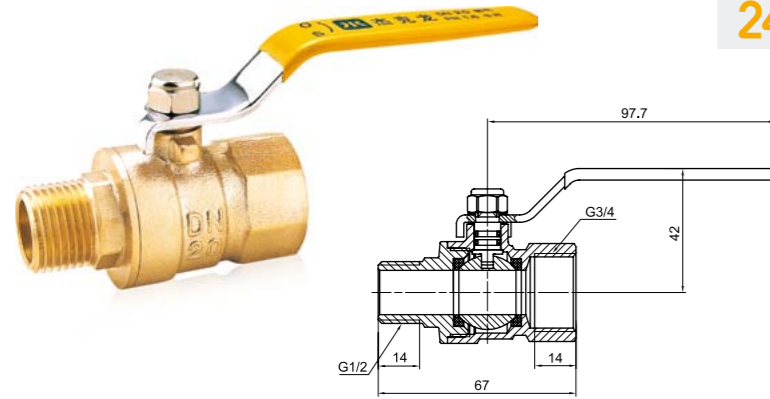

241 黄铜内外螺纹燃气球阀
Brass Gas Ball Valve MF (RQL-PN16)

技术规范

公称压力: 1.6 MPa
工作介质: 天然气、人工煤气、液化石油气
工作温度: $-20^{\circ}\text{C} \leq t \leq 110^{\circ}\text{C}$
圆柱管螺纹符合ISO228标准

Technical Standard

Nominal Pressure: 1.6 MPa
Working Medium: Natural Gas, Artificial Gas, Liquefied Petroleum Gas
Working Temperature: $-20^{\circ}\text{C} \leq t \leq 110^{\circ}\text{C}$
Parallel Pipe Thread to ISO228

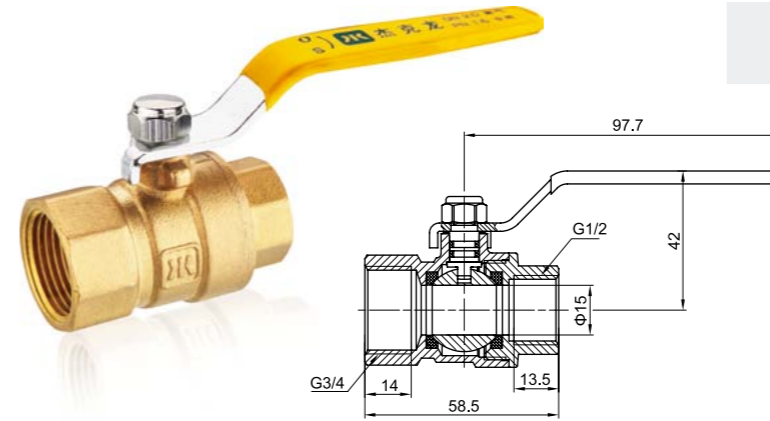

242 黄铜异径内螺纹燃气球阀
Brass Female Reduced Gas Ball Valve (RQL-PN16)

技术规范

公称压力: 1.6 MPa
工作介质: 天然气、人工煤气、液化石油气
工作温度: $-20^{\circ}\text{C} \leq t \leq 110^{\circ}\text{C}$
圆柱管螺纹符合ISO228标准

Technical Standard

Nominal Pressure: 1.6 MPa
Working Medium: Natural Gas, Artificial Gas, Liquefied Petroleum Gas
Working Temperature: $-20^{\circ}\text{C} \leq t \leq 110^{\circ}\text{C}$
Parallel Pipe Thread to ISO228

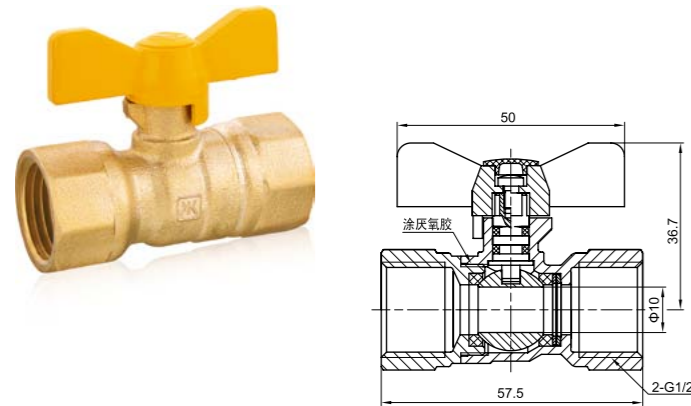

237 黄铜内螺纹防泄漏燃气球阀
Brass Female Leakproof Gas Ball Valve (RQL-PN16)

技术规范

公称压力: 1.6 MPa
工作介质: 天然气、人工煤气、液化石油气
工作温度: $-20^{\circ}\text{C} \leq t \leq 110^{\circ}\text{C}$
圆锥管螺纹符合ISO7标准
圆柱管螺纹符合ISO228标准

Technical Standard

Nominal Pressure: 1.6 MPa
Working Medium: Natural Gas, Artificial Gas, Liquefied Petroleum Gas
Working Temperature: $-20^{\circ}\text{C} \leq t \leq 110^{\circ}\text{C}$
Taper Pipe Thread to ISO7
Parallel Pipe Thread to ISO228

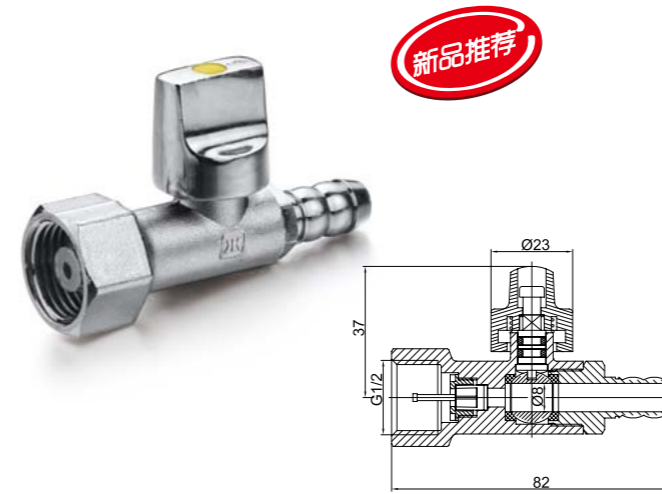

★ 旋钮采用下压结构，阀门具有自动过流切断功能。

R10110 黄铜内直嘴自动切断球阀
Automatic Shut-off Gas Ball Valve (RQJ-PN0.15)

产品特点:

1. 胶管脱落可实现自动切断介质。
2. 防儿童锁结构设计。
3. 产品介质切断后只能通过人工复位后正常工作。

技术规范

公称压力: 0.015MPa
工作介质: 天然气、人工煤气、液化石油气
工作温度: $-20^{\circ}\text{C} \leq t \leq 80^{\circ}\text{C}$
圆柱管螺纹符合ISO228标准
过断流量: 1.2m³/h

Technical Standard

Nominal Pressure: 0.015MPa
Working Medium: Natural Gas, Artificial Gas, Liquefied Petroleum Gas
Working Temperature: $-20^{\circ}\text{C} \leq t \leq 80^{\circ}\text{C}$
Parallel Pipe Thread to ISO228
Shutoff During Overflow: 1.2m³/h

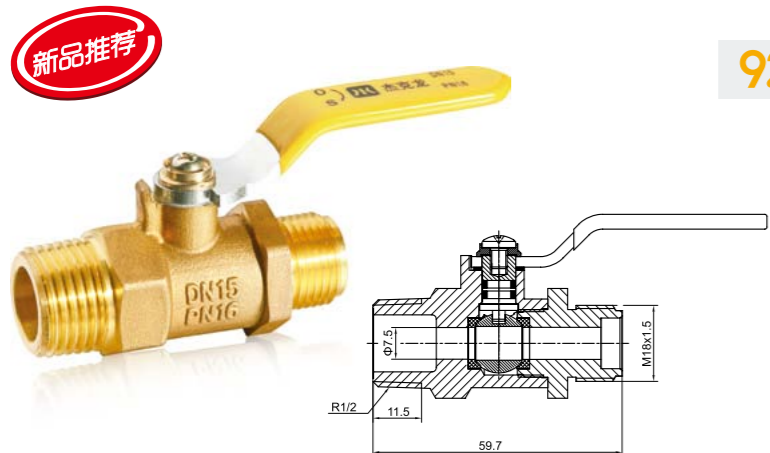

9252 黄铜燃气球阀
Brass Gas Ball Valve (RQL-PN16)

技术规范

公称压力: 1.6 MPa
工作介质: 天然气、人工煤气、液化石油气
工作温度: $-20^{\circ}\text{C} \leq t \leq 110^{\circ}\text{C}$
圆柱管螺纹符合ISO228标准

Technical Standard

Nominal Pressure: 1.6 MPa
Working Medium: Natural Gas, Artificial Gas, Liquefied Petroleum Gas
Working Temperature: $-20^{\circ}\text{C} \leq t \leq 110^{\circ}\text{C}$
Parallel Pipe Thread to ISO228

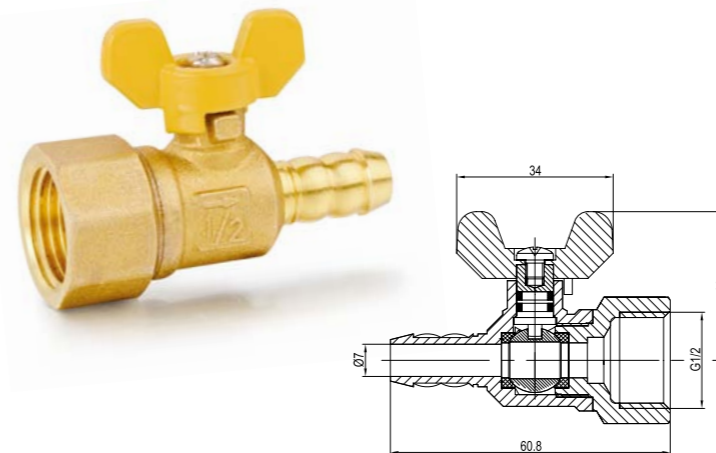

9233 黄铜内螺纹燃气直嘴φ9.5
Brass Female Thread Integral Leakproof Gas Ball Valve (RQJ-PN0.15)

技术规范

公称压力: 0.015MPa
工作介质: 天然气、人工煤气、液化石油气
工作温度: $-20^{\circ}\text{C} \leq t \leq 110^{\circ}\text{C}$
圆柱管螺纹符合ISO228标准

Technical Standard

Nominal Pressure: 0.015MPa
Working Medium: Natural Gas, Artificial Gas, Liquefied Petroleum Gas
Working Temperature: $-20^{\circ}\text{C} \leq t \leq 110^{\circ}\text{C}$
Parallel Pipe Thread to ISO228

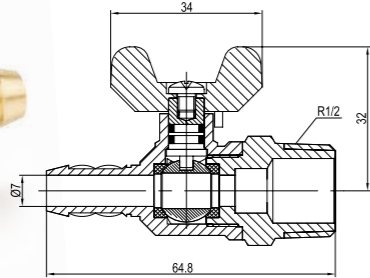

9234 黄铜外螺纹燃气直嘴φ9.5
Brass Male Screw Leakproof Gas Ball Valve With Mouth (RQJ-PN0.15)

技术规范

公称压力: 0.015MPa
工作介质: 天然气、人工煤气、液化石油气
工作温度: -20℃≤t≤110℃
圆锥管螺纹符合ISO7标准

Technical Standard

Nominal Pressure: 0.015 MPa
Working Medium: Natural gas, Artificial gas, Liquefied petroleum gas
Working Temperature: -20℃≤t≤110℃
Parallel Pipe to ISO7



236

黄铜内螺纹双接管防泄漏燃气球阀
Brass Female Screw Leakproof Gas Ball Valve With Double Mouth (RQJ-PN0.15)



235

黄铜外螺纹双接管防泄漏燃气球阀
Brass Male Screw Leakproof Gas Ball Valve With Double Mouth (RQJ-PN0.15)



247

黄铜燃气球阀
Brass Gas Ball Valve (RQT-PN0.15)



9201

黄铜铝塑管内丝燃气球阀
Brass Gas Ball Valve Fx F For PEX-Al-PEX (RQT-PN16)



9202

黄铜铝塑管外丝燃气球阀
Brass Gas Ball Valve Mx F For PEX-Al-PEX (RQT-PN16)



9203

黄铜铝塑管燃气球阀
Brass Gas Ball Valve For PEX-Al-PEX (RQT-PN16)

燃气立管专用系列
GAS BALL VALVES FOR GAS PIPES

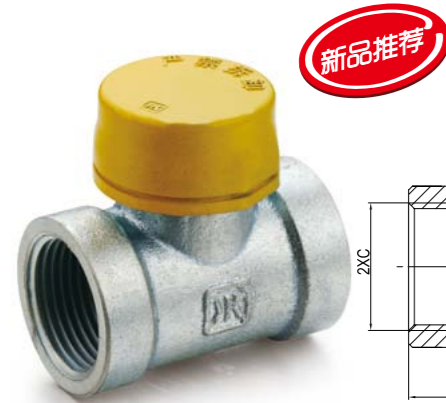

TF-300 防拆异径三通
Anti-theft Reducing Tee

产品特点:

1. 预留口防拆罩一旦破坏不可复原。
2. 防拆罩黄色警示标识, 并带“严禁拆卸”字样。
3. 预留口为全径尺寸。

技术规范

公称压力: 0.8MPa
工作介质: 天然气、人工煤气、液化石油气
工作温度: -20℃≤t≤110℃
圆锥管螺纹符合ISO7标准
圆柱管螺纹符合ISO228标准

Technical Standard

Nominal Pressure: 0.8 MPa
Working Medium: Natural gas, Artificial gas, Liquefied petroleum gas
Working Temperature: -20℃≤t≤110℃
Taper Pipe Thread to ISO7
Parallel Pipe Thread to ISO228

DN	A	B	C
25	65	48	G1xG1
32	70	53	G1 ¹ / ₄ xG1 ¹ / ₄
40	87	55	G1 ¹ / ₂ xG1 ¹ / ₂
50	100	68	G2xG2

测压系列燃气球阀
PRESSURE TESTING GAS BALL VALVE

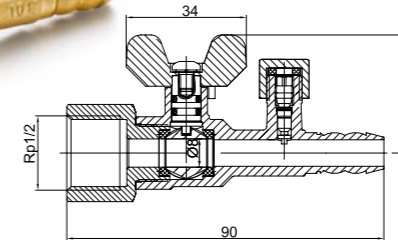

新品推荐

★可实现带气测压, 测压时使用专用测压工具。

R10001 黄铜内直嘴测压球阀
Gas Ball Valve With Nozzle (RQJ-PN0.15)

技术规范

公称压力: 0.015MPa
工作介质: 天然气、人工煤气、液化石油气
工作温度: -20℃≤t≤110℃
圆锥管螺纹符合ISO7标准
圆柱管螺纹符合ISO228标准

Technical Standard

Nominal Pressure: 0.015 MPa
Working Medium: Natural gas, Artificial gas, Liquefied petroleum gas
Working Temperature: -20℃≤t≤110℃
Taper Pipe Thread to ISO7
Parallel Pipe Thread to ISO228

密封件选用M111/日本大金材料
O型圈选用意大利NBR材料, 符合EN682标准

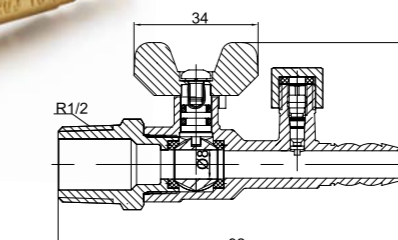

新品推荐

★可实现带气测压, 测压时使用专用测压工具。

R10002 黄铜外直嘴测压球阀
Gas Ball Valve With Nozzle (RQJ-PN0.15)

技术规范

公称压力: 0.015MPa
工作介质: 天然气、人工煤气、液化石油气
工作温度: -20℃≤t≤110℃
圆锥管螺纹符合ISO7标准
圆柱管螺纹符合ISO228标准

Technical Standard

Nominal Pressure: 0.015 MPa
Working Medium: Natural gas, Artificial gas, Liquefied petroleum gas
Working Temperature: -20℃≤t≤110℃
Taper Pipe Thread to ISO7
Parallel Pipe Thread to ISO228

密封件选用M111/日本大金材料
O型圈选用意大利NBR材料, 符合EN682标准

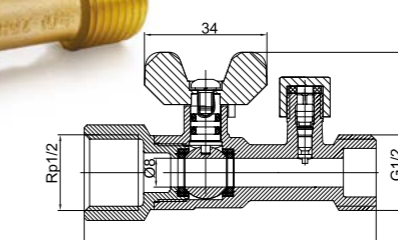

新品推荐

★可实现带气测压, 测压时使用专用测压工具。

R10102 黄铜外螺纹测压球阀
Gas Ball Valve MM (RQZ-PN0.15)

技术规范

公称压力: 0.015MPa
工作介质: 天然气、人工煤气、液化石油气
工作温度: -20℃≤t≤110℃
圆锥管螺纹符合ISO7标准
圆柱管螺纹符合ISO228标准

Technical Standard

Nominal Pressure: 0.015 MPa
Working Medium: Natural gas, Artificial gas, Liquefied petroleum gas
Working Temperature: -20℃≤t≤110℃
Taper Pipe Thread to ISO7
Parallel Pipe Thread to ISO228

密封件选用M111/日本大金材料
O型圈选用意大利NBR材料, 符合EN682标准

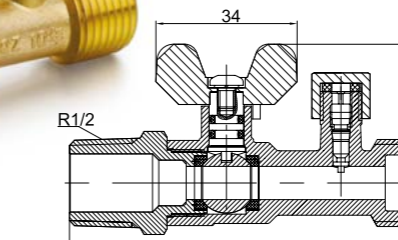

新品推荐

★可实现带气测压, 测压时使用专用测压工具。

R10101 黄铜内外螺纹测压球阀
Gas Ball Valve FM (RQZ-PN0.15)

技术规范

公称压力: 0.015MPa
工作介质: 天然气、人工煤气、液化石油气
工作温度: -20℃≤t≤110℃
圆锥管螺纹符合ISO7标准
圆柱管螺纹符合ISO228标准

Technical Standard

Nominal Pressure: 0.015 MPa
Working Medium: Natural gas, Artificial gas, Liquefied petroleum gas
Working Temperature: -20℃≤t≤110℃
Taper Pipe Thread to ISO7
Parallel Pipe Thread to ISO228

密封件选用M111/日本大金材料
O型圈选用意大利NBR材料, 符合EN682标准

波纹管燃气球阀系列
GAS BALL VALVE FOR WAVY HOSES

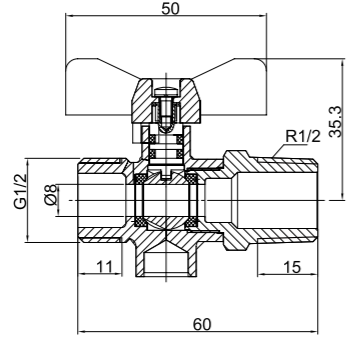

R10201 黄铜外螺纹带底座球阀
Gas Ball Valve MM (RQZ-PN0.15)

技术规范	Technical Standard
公称压力: 0.015MPa	Nominal Pressure: 0.015 MPa
工作介质: 天然气、人工煤气、液化石油气	Working Medium: Natural gas, Artificial gas, Liquefied petroleum gas
工作温度: $-20^{\circ}\text{C} \leq t \leq 110^{\circ}\text{C}$	Working Temperature: $-20^{\circ}\text{C} \leq t \leq 110^{\circ}\text{C}$
圆锥管螺纹符合ISO7标准	Taper Pipe Thread to ISO7
圆柱管螺纹符合ISO228标准	Parallel Pipe Thread to ISO228

密封件选用M111/日本大金材料
O型圈选用意大利NBR材料, 符合EN682标准

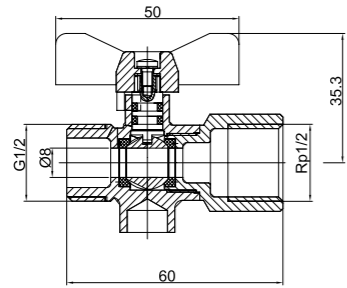

R10202 黄铜内外螺纹带底座球阀
Gas Ball Valve FM (RQZ-PN0.15)

技术规范	Technical Standard
公称压力: 0.015MPa	Nominal Pressure: 0.015 MPa
工作介质: 天然气、人工煤气、液化石油气	Working Medium: Natural gas, Artificial gas, Liquefied petroleum gas
工作温度: $-20^{\circ}\text{C} \leq t \leq 110^{\circ}\text{C}$	Working Temperature: $-20^{\circ}\text{C} \leq t \leq 110^{\circ}\text{C}$
圆锥管螺纹符合ISO7标准	Taper Pipe Thread to ISO7
圆柱管螺纹符合ISO228标准	Parallel Pipe Thread to ISO228

密封件选用M111/日本大金材料
O型圈选用意大利NBR材料, 符合EN682标准

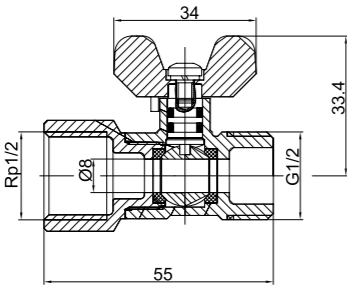

R10401 黄铜内外螺纹波纹管球阀
Gas Ball Valve FM (RQZ-PN0.15)

技术规范	Technical Standard
公称压力: 0.015MPa	Nominal Pressure: 0.015 MPa
工作介质: 天然气、人工煤气、液化石油气	Working Medium: Natural gas, Artificial gas, Liquefied petroleum gas
工作温度: $-20^{\circ}\text{C} \leq t \leq 110^{\circ}\text{C}$	Working Temperature: $-20^{\circ}\text{C} \leq t \leq 110^{\circ}\text{C}$
圆锥管螺纹符合ISO7标准	Taper Pipe Thread to ISO7
圆柱管螺纹符合ISO228标准	Parallel Pipe Thread to ISO228

密封件选用M111/日本大金材料
O型圈选用意大利NBR材料, 符合EN682标准

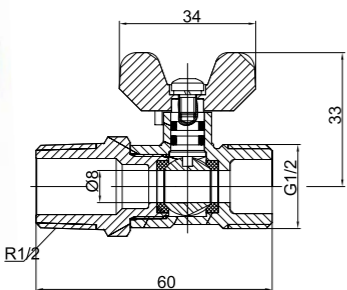

R10402 黄铜外螺纹波纹管球阀
Gas Ball Valve MM (RQZ-PN0.15)

技术规范	Technical Standard
公称压力: 0.015MPa	Nominal Pressure: 0.015 MPa
工作介质: 天然气、人工煤气、液化石油气	Working Medium: Natural gas, Artificial gas, Liquefied petroleum gas
工作温度: $-20^{\circ}\text{C} \leq t \leq 110^{\circ}\text{C}$	Working Temperature: $-20^{\circ}\text{C} \leq t \leq 110^{\circ}\text{C}$
圆锥管螺纹符合ISO7标准	Taper Pipe Thread to ISO7
圆柱管螺纹符合ISO228标准	Parallel Pipe Thread to ISO228

密封件选用M111/日本大金材料
O型圈选用意大利NBR材料, 符合EN682标准

燃气表接头系列
COUPLINGS FOR GAS METERS



T-219

黄铜燃气表接头



T-200

黄铜弯管燃气表接头



TC-900

黄铜测压燃气表接头



4602

黄铜燃气表接头

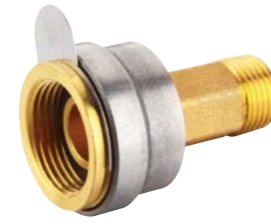

T120A

防盗燃气表接头

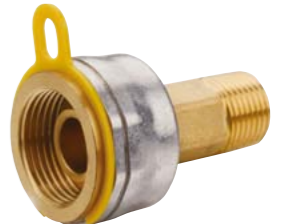

TF-901

黄铜防盗燃气表接头



T-217

防盗燃气表接头



T213

碳钢燃气表接头



T214

碳钢防盗燃气表接头



T216

黄铜弯管接头



T206

黄铜铝塑管45°燃气表接头



T210

内丝直接表接头



T210

黄铜铝塑管90°燃气表接头

燃气铝塑专用管件
FITTINGS FOR GAS AL-PLASTIC PIPES

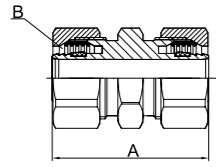
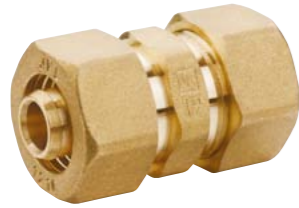

Size	A	B
S1216x1216	47	1216
S1418x1418	50	1418
S1620x1620	50	1620

F100 黄铜铝塑复合管接头
等径直通管接头

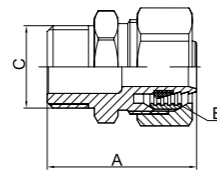

Size	A	B	C
S1216x1/2M	37	1216	1/2
S1418x1/2M	38	1418	1/2

F100 黄铜铝塑复合管接头
外牙直通管接头

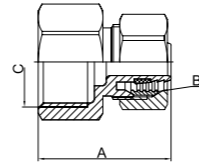
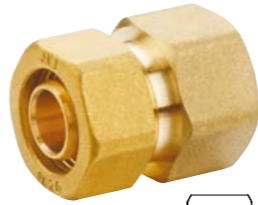

Size	A	B	C
S1216x1/2F	36	1216	1/2
S1216x3/4F	39	1216	1/2
S1418x1/2F	38	1418	1/2
S1620x3/4F	39	1620	3/4

F100 黄铜铝塑复合管接头
内牙直通管接头

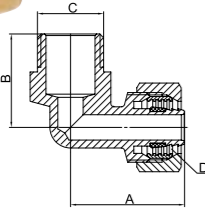
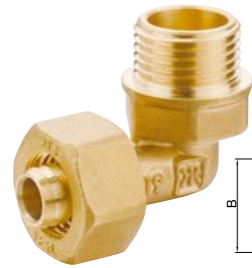

Size	A	B	C	D
L1216x1/2M	36	29.5	1/2	1216

F100 黄铜铝塑复合管接头
外牙弯头

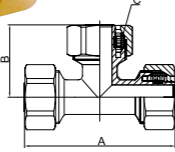

Size	A	B	C
T1216x1216x1216	68	33	1216
T1418x1418x1418	70	34	1418
T1620x1620x1620	74	35.5	1620

F100 黄铜铝塑复合管接头
等径三通管接头

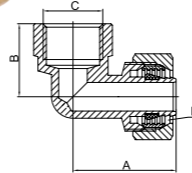

Size	A	B	C	D
L1216x1/2F	36	24.5	1/2	1216
L1418x1/2F	36	25.5	1/2	1418
L1620x1/2F	36	26	1/2	1620

F100 黄铜铝塑复合管接头
内牙弯头

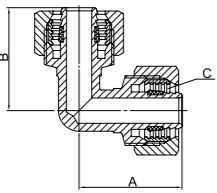
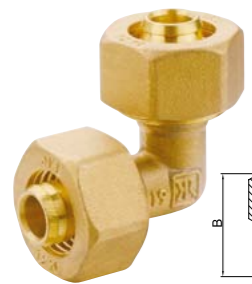

Size	A	B	C
L1216x1216	32.5	32.5	1216

F100
等径弯头

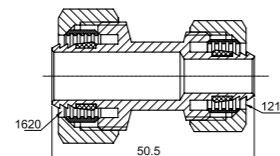
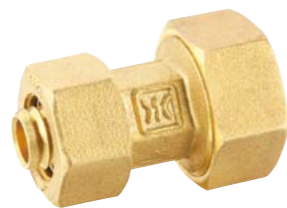

S1216x1620

T-210
异径直接

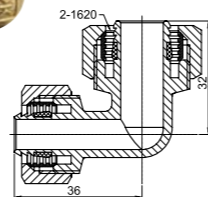

L1216x1620

T-210
异径弯头

燃气铝塑专用管件
FITTINGS FOR GAS AL-PLASTIC PIPES

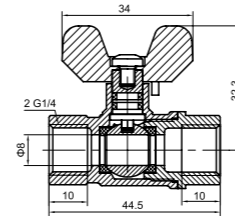

9204
黄铜内螺纹球阀

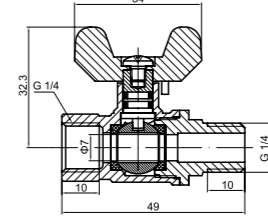

9212
黄铜内外螺纹球阀

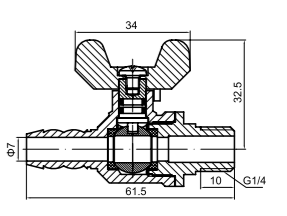

9213
黄铜内外螺纹球阀

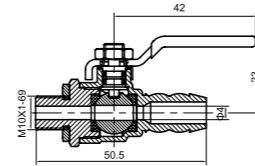

9214
黄铜外丝直嘴球阀

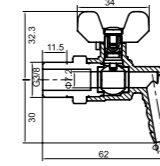

9210
黄铜外丝弯嘴球阀



卓越精工, 自然出众!

其它配件
OTHER ACCESSORIES



T119
燃气格林接头



SJ-806
陶瓷三角阀



209
黄铜PPR球阀

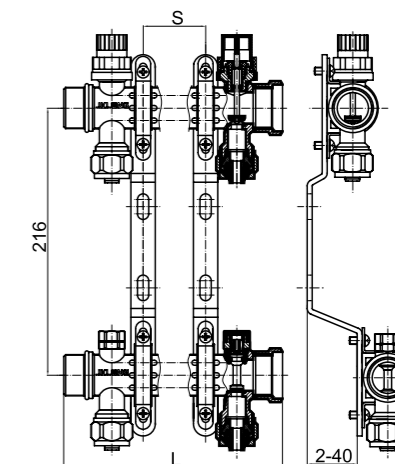

F613 一体式调节分集水器

Integrated Regulating Manifold

技术规范

材质: 黄铜本色
公称压力: PN16
介质温度: $0^{\circ}\text{C} \leq t \leq 100^{\circ}\text{C}$
主管通径: DN25
支管规格: 1216/1620
间距: 50mm
连接端口: G1"外螺纹xG1"内螺纹
控制接口: M30X1.5mm, 行程3mm(14-11)

Technical Standard

Material: Brass
Nominal Pressure: 1.6Mpa
Working Temperature: $0^{\circ}\text{C} \leq t \leq 100^{\circ}\text{C}$
Main Pipe Size: DN25
Branch Pipe Size: 1216/1620
Connector: G1"male xG1"female
Control Connector: M30X1.5mm

路数 (n)	2	3	4	5	6
支路间距	50				
总长 (L)	123	173	223	273	323
支架间距 (S)	/	50	100	150	200

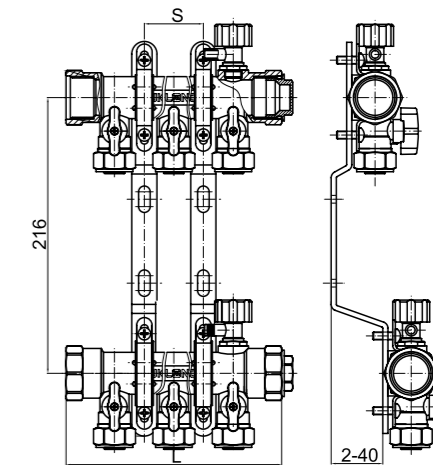

F614 一体式球阀型分集水器

Integrated Manifold With Ball Valve

技术规范

材质: 黄铜表面镀镍
公称压力: PN16
使用温度: $0^{\circ}\text{C} \leq t \leq 100^{\circ}\text{C}$
主管通径: DN25
支管规格: 1216/1620
间距: 46mm
连接接口: 2xG1"内螺纹

Technical Standard

Material: Brass
Nominal Pressure: 1.6Mpa
Working Temperature: $0^{\circ}\text{C} \leq t \leq 100^{\circ}\text{C}$
Main Pipe Size: DN25
Branch Pipe Size: 1216/1620
Interval: 46mm
Connector: 2xG1"female

路数 (n)	2	3	4	5	6
支路间距	46				
总长 (L)	121	167	213	259	305
支架间距 (S)	/	46	92	138	184

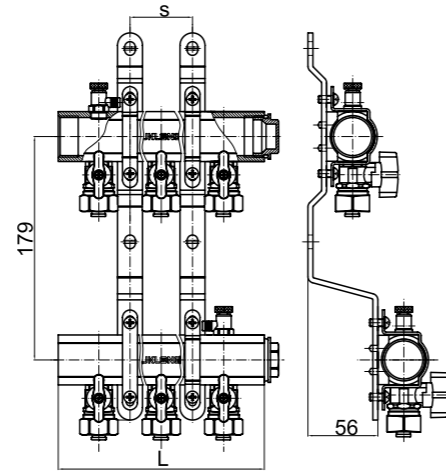
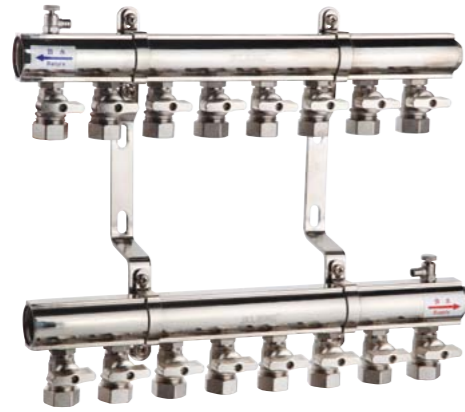

F616 型材式球阀型分集水器
Strip-type Manifold With Ball Valve

技术规范
材质: 黄铜表面镀镍
公称压力: PN16
使用温度: 0°C≤t≤100°C
主管通径: DN25
支管规格: 1216/1620 间距: 50mm
连接接口: 2xG1"内螺纹

Technical Standard
Material: Brass
Nominal Pressure: 1.6Mpa
Working Temperature: 0°C≤t≤100°C
Main Pipe Size: DN25
Branch Pipe Size: 1216/1620
Interval: 50mm
Connector: 2xG1"female

路数 (n)	2	3	4	5	6	7	8	9	10
支路间距	50								
总长 (L)	105	155	205	255	305	355	405	455	505
支架间距 (S)	/	50	100	150	200	250	300	350	400

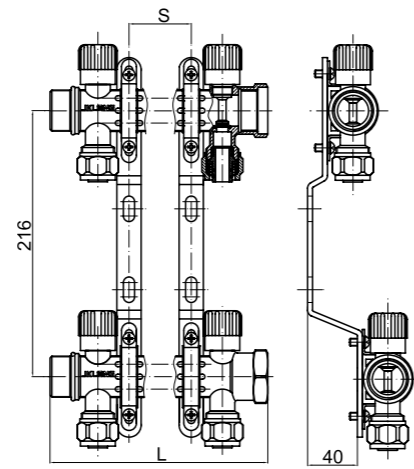

F613A 一体式手动调节型分集水器
Integrated Regulating Manifold

技术规范
材质: 黄铜本色
公称压力: PN16
介质温度: 0°C≤t≤100°C
主管通径: DN25
支管规格: 1216/1620
间距: 50mm连接端口: G1"外螺纹xG1"内螺纹

Technical Standard
Material: Brass
Nominal Pressure: 1.6Mpa
Working Temperature: 0°C≤t≤100°C
Main Pipe Size: DN25
Branch Pipe Size: 1216/1620
Connector: G1"male xG1"female

路数 (n)	2	3	4	5	6
支路间距	50				
总长 (L)	123	173	223	273	323
支架间距 (S)	/	50	100	150	200



769/770 电热温控调节阀
Electric Heating Valve

特点
采用电热执行器与截止型阀体结合使用, 更加安静, 推力稳定。
采用截止控制, 可实现开启高度任意控制。
驱动器之平面设计可以贴近墙面安装, 占用空间小。产品可靠耐用, 工作噪音低。

技术参数

规格	联接螺纹	工作介质	流体温度	环境温度	公称压力	电气规格
DN25	G1"	冷冻水/热水	0-94°C	0-40°C	1.6 MPa	24V(定制) 220V(常规)
DN32	G1 1/4"					

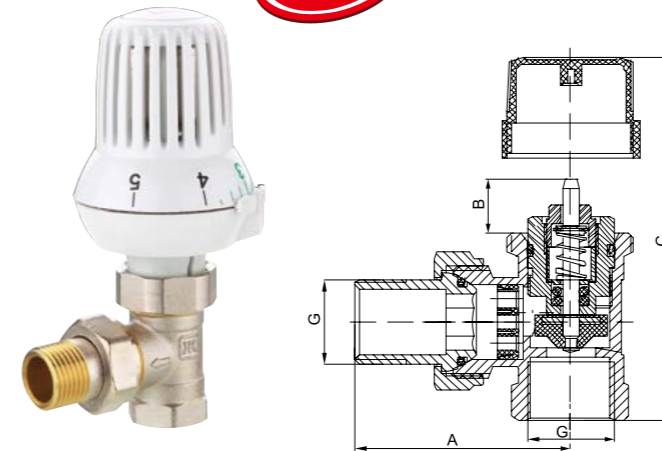

具有带水带压换阀芯的功能;
配有专用安装工具, 极大提高产品安装及维护效率。

371 黄铜自动温控阀
Brass Automatic-controlled Radiator(J34W-16T)

技术规范
公称压力: 1.6 MPa
工作介质: 水、饱和蒸汽 (≤0.6MPa)
工作温度: 0°C≤t≤120°C
温控范围: 6°C~28°C
圆柱管螺纹符合ISO228标准

Technical Standard
Nominal Pressure: 1.6 Mpa
Working Medium: Water,Saturated steam(≤0.6MPa)
Working Temperature: 0°C≤t≤120°C
Temperature Range: 6°C~28°C
Parallel Pipe Thread to ISO228

DN	Size	A	B	C	G
15	1/2	51.5	13.4	62.4	1/2
20	3/4	57.5	13.4	65.7	3/4
25	1	62.5	13.4	73.7	1

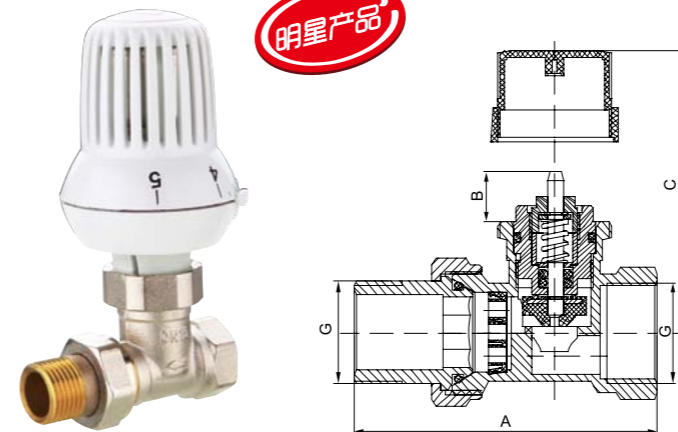

具有带水带压换阀芯的功能;
配有专用安装工具, 极大提高产品安装及维护效率。

372 黄铜自动温控阀
Brass Automatic-controlled Radiator(J34W-16T)

技术规范
公称压力: 1.6 MPa
工作介质: 水、饱和蒸汽 (≤0.6MPa)
工作温度: 0°C≤t≤120°C
温控范围: 6°C~28°C
圆柱管螺纹符合ISO228标准

Technical Standard
Nominal Pressure: 1.6 Mpa
Working Medium: Water,Saturated steam(≤0.6MPa)
Working Temperature: 0°C≤t≤120°C
Temperature Range: 6°C~28°C
Parallel Pipe Thread to ISO228

DN	Size	A	B	C	G
15	1/2	74.5	13.4	48.7	1/2
20	3/4	79.5	13.4	49.7	3/4
25	1	83.5	13.4	50.7	1

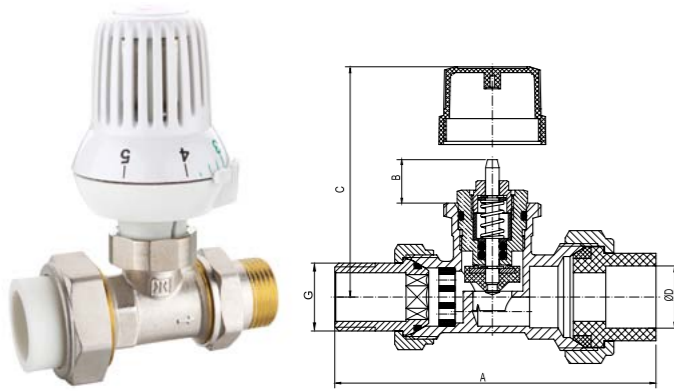

具有带水带压换阀芯的功能；
配有专用安装工具，极大提高产品安装及维护效率。

374 PPR黄铜自动温控阀(高阻尼) Brass Automatic-controlled Radiator(J34W-16T)

技术规范	Technical Standard
公称压力: 1.6 MPa	Nominal Pressure: 1.6 MPa
工作介质: 水、饱和蒸汽 (≤0.6MPa)	Working Medium: Water,Saturated steam(≤0.6MPa)
工作温度: 0°C≤t≤120°C	Working Temperature: 0°C≤t≤120°C
温控范围: 6°C~28°C	Temperature Range: 6°C~28°C
圆柱管螺纹符合ISO228标准	Parallel Pipe Thread to ISO228

备注: 接头材质可选择PPR、PB、PERT

DN	G	A	B	C	D
15	1/2	98	13.4	48.7	19.2
20	3/4	106.4	13.4	48.7	24.1
25	1	115	13.4	48.7	31

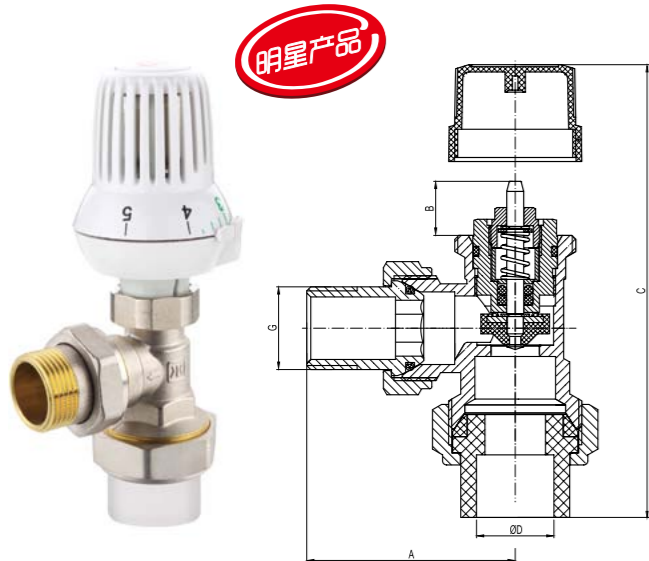

具有带水带压换阀芯的功能；
配有专用安装工具，极大提高产品安装及维护效率。

364 PPR黄铜自动温控阀 Brass Automatic-controlled Radiator(J34W-16T)

技术规范	Technical Standard
公称压力: 1.6 MPa	Nominal Pressure: 1.6 MPa
工作介质: 水、饱和蒸汽 (≤0.6MPa)	Working Medium: Water,Saturated steam(≤0.6MPa)
工作温度: 0°C≤t≤120°C	Working Temperature: 0°C≤t≤120°C
温控范围: 6°C~28°C	Temperature Range: 6°C~28°C
圆柱管螺纹符合ISO228标准	Parallel Pipe Thread to ISO228

备注: 接头材质可选择PPR、PB、PERT

DN	G	A	B	C	D
15	1/2	51.5	13.4	62.4	19.2
20	3/4	57.5	13.4	94.7	24.1
25	1	62.2	13.4	106	31

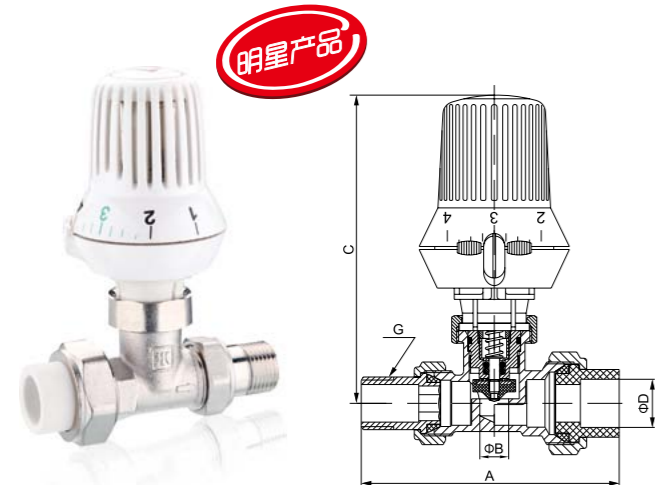

具有带水带压换阀芯的功能；
配有专用安装工具，极大提高产品安装及维护效率。

365 黄铜PB自动温控阀 Brass PB Automatic-controlled Radiator (J61W-16T)

技术规范	Technical Standard
公称压力: 1.6 MPa	Nominal Pressure: 1.6 MPa
工作介质: 水、饱和蒸汽 (≤0.6MPa)	Working Medium: Water,Saturated steam(≤0.6MPa)
工作温度: 0°C≤t≤120°C	Working Temperature: 0°C≤t≤120°C
温控范围: 6°C~28°C	Temperature Range: 6°C~28°C
圆柱管螺纹符合ISO228标准	Parallel Pipe Thread to ISO228

备注: 接头材质可选择PPR、PB、PERT

DN	Size	A	B	C	D	G
15	1/2	103	13	122	19.2	1/2
20	3/4	113	13	122	24.1	3/4

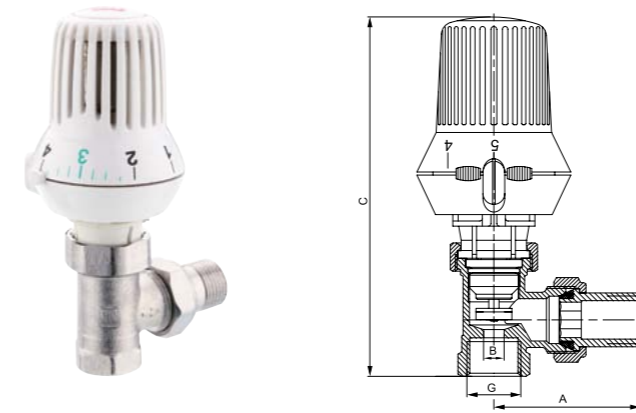

具有带水带压换阀芯的功能；
配有专用安装工具，极大提高产品安装及维护效率。

368 黄铜自动温控阀 Brass Automatic-controlled Radiator(J34W-16T)

技术规范	Technical Standard
公称压力: 1.6 MPa	Nominal Pressure: 1.6 MPa
工作介质: 水、饱和蒸汽 (≤0.6MPa)	Working Medium: Water,Saturated steam(≤0.6MPa)
工作温度: 0°C≤t≤120°C	Working Temperature: 0°C≤t≤120°C
温控范围: 6°C~28°C	Temperature Range: 6°C~28°C
圆柱管螺纹符合ISO228标准	Parallel Pipe Thread to ISO228

DN	Size	A	B	C	G
15	1/2	57	8	140	1/2
20	3/4	63	8	140	3/4

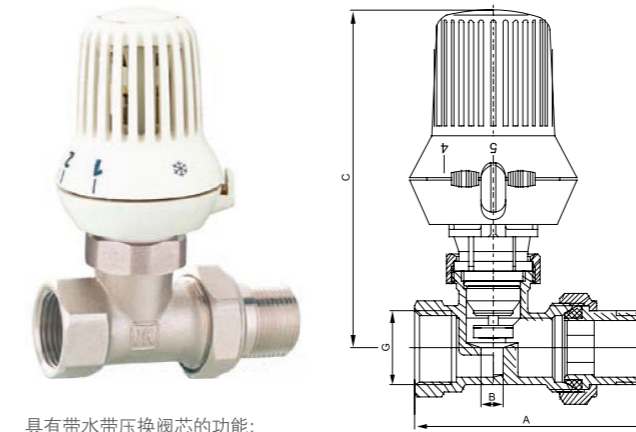

具有带水带压换阀芯的功能；
配有专用安装工具，极大提高产品安装及维护效率。

369 黄铜自动温控阀 Brass Automatic-controlled Radiator(J34W-16T)

技术规范	Technical Standard
公称压力: 1.6 MPa	Nominal Pressure: 1.6 MPa
工作介质: 水、饱和蒸汽 (≤0.6MPa)	Working Medium: Water,Saturated steam(≤0.6MPa)
工作温度: 0°C≤t≤120°C	Working Temperature: 0°C≤t≤120°C
温控范围: 6°C~28°C	Temperature Range: 6°C~28°C
圆柱管螺纹符合ISO228标准	Parallel Pipe Thread to ISO228

DN	Size	A	B	C	G
15	1/2	81	12	122	1/2
20	3/4	88.5	13	122	3/4
25	1	90.5	14	122	1

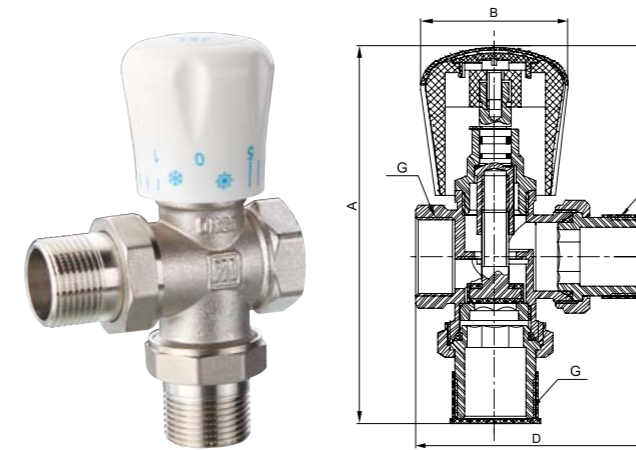

363 黄铜三通温控手动调节阀 Brass 3-way Hand Temperature-controlled Valve(J38X-16T)

技术规范	Technical Standard
公称压力: 1.6 MPa	Nominal Pressure: 1.6 MPa
工作介质: 水、饱和蒸汽 (≤0.6MPa)	Working Medium: Water,Saturated steam(≤0.6MPa)
工作温度: t≤120°C	Working Temperature: t≤120°C
圆柱管螺纹符合ISO228标准	Parallel Pipe Thread to ISO228

DN	Size	A	B	C	D	G
20	3/4	124	48.7	69	80	3/4
25	1	137.5	48.7	75	88	1
32	1 1/4	157	54.7	81	105	1 1/4

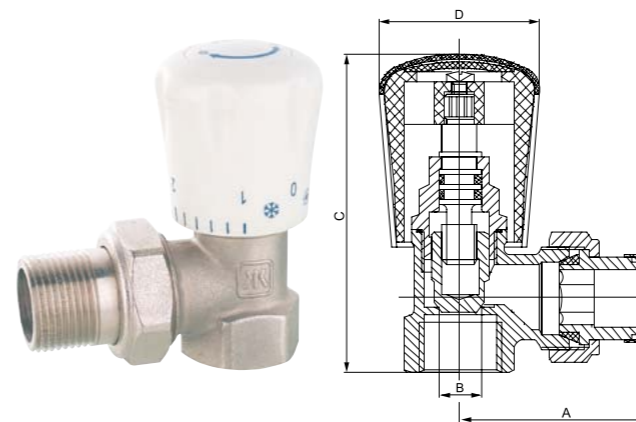

338 黄铜温控手动调节阀 Brass Hand Temperature-controlled Valve (J31W-16T)

技术规范	Technical Standard
公称压力: 1.6 MPa	Nominal Pressure: 1.6 MPa
工作介质: 水、饱和蒸汽 (≤0.6MPa)	Working Medium: Water,Saturated steam(≤0.6MPa)
工作温度: -10°C≤t≤120°C	Working Temperature: -10°C≤t≤120°C
圆锥管螺纹符合ISO7标准 圆柱管螺纹符合ISO228标准	Taper Pipe Thread to ISO7 Parallel Pipe Thread to ISO228

DN	Size	A	B	C	D
15	1/2	59	11	81.5	41
20	3/4	62.5	15.5	88.35	48
25	1	67.4	19	93.3	48.7

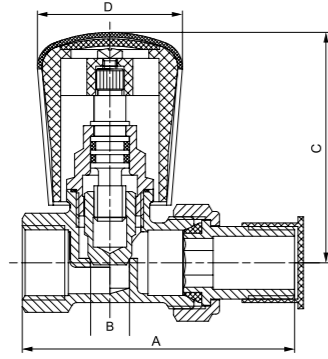

339 黄铜温控手动调节阀
Brass Hand Temperature-controlled Valve (J31W-16T)

技术规范
公称压力: 1.6 MPa
工作介质: 水、饱和蒸汽
(≤0.6Mpa)
工作温度: -10℃≤t≤120℃
圆锥管螺纹符合ISO7标准
圆柱管螺纹符合ISO228标准

Technical Standard
Nominal Pressure: 1.6 Mpa
Working Medium: Water, Saturated steam (≤0.6Mpa)
Working Temperature: -10℃≤t≤120℃
Taper Pipe Thread to ISO7
Parallel Pipe Thread to ISO228

DN	Size	A	B	C	D
15	1/2	79	11	66	41
20	3/4	90	72.3	88.35	48
25	1	97.5	19	73.3	48.7

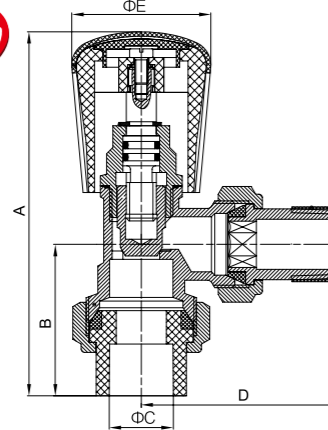

340 黄铜温控PPR手动调节阀
Brass Hand Temperature-controlled Valve With PPR (J64W-16T)

技术规范
公称压力: 1.6 MPa
工作介质: 水、饱和蒸汽
(≤0.6Mpa)
工作温度: t≤120℃
圆柱管螺纹符合ISO228标准

Technical Standard
Nominal Pressure: 1.6 Mpa
Working Medium: Water, Saturated steam (≤0.6Mpa)
Working Temperature: t≤120℃
Parallel Pipe Thread to ISO228

备注: 接头材质可选择PPR、PB、PERT

DN	A	B	C	D	E
15	109	45.5	19.2	59.5	41
20	121.5	53.5	24	62.5	48

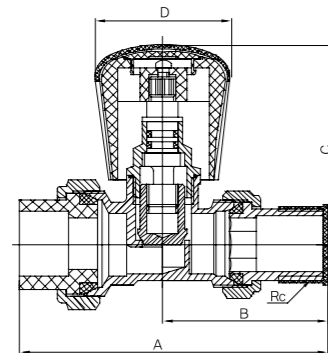

345 黄铜温控PPR手动调节阀
Brass Hand Temperature-controlled Valve With PPR (J64W-16T)

技术规范
公称压力: 1.6 MPa
工作介质: 水、饱和蒸汽
(≤0.6Mpa)
工作温度: -10℃≤t≤120℃
圆柱管螺纹符合ISO228标准

Technical Standard
Nominal Pressure: 1.6 Mpa
Working Medium: Water, Saturated steam (≤0.6Mpa)
Working Temperature: -10℃≤t≤120℃
Parallel Pipe Thread to ISO228

备注: 接头材质可选择PPR、PB、PERT

DN	Size	A	B	C	D	Rc
15	1/2	103	52.5	66	41	1/2
20	3/4	112	60	73	48	3/4

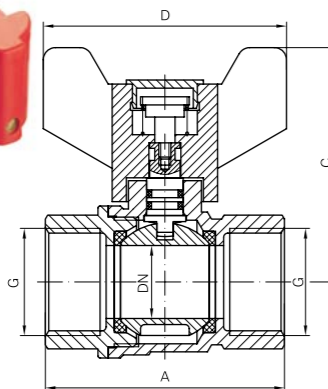

9269 黄铜多功能锁式球阀
Brass Multifunctional Lockable Ball Valve (Q11F-16T)

技术规范
公称压力: 1.6 MPa
工作介质: 水、非腐蚀性液体
(-20℃≤t≤110℃)
圆柱管螺纹符合ISO228标准

Technical Standard
Nominal Pressure: 1.6 Mpa
Working Medium: Water, Non-causticity liquid
Working Temperature: -20℃≤t≤110℃
Parallel Pipe Thread to ISO228

备注: 接头材质可选择PPR、PB、PERT

Size	DN	A	C	D	G
20	18	59	58	60	3/4
25	18	71	65	60	1

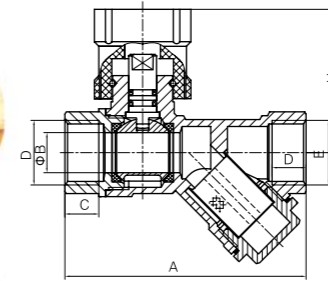

284 黄铜锁式过滤球阀
Brass Lockable Ball Valve With Filter (Q11F-16T)

技术规范
公称压力: 1.6 MPa
工作介质: 水、非腐蚀性液体
(-20℃≤t≤100℃)
圆柱管螺纹符合ISO228标准

Technical Standard
Nominal Pressure: 1.6 Mpa
Working Medium: Water, Non-causticity liquid
Working Temperature: -20℃≤t≤100℃
Parallel Pipe Thread to ISO228

备注: 接头材质可选择PPR、PB、PERT

DN	A	B	C	D	E	H
15	78.2	13	11	11	G1/2	46.5
20	84	18	12.5	11	G3/4	50
25	101.8	23.5	13	13	G1	54.5
32	125.3	30	14	14.5	G1 1/4	59.5



640
电热执行器
Electrothermal Actuator



640A
电热执行器
Electrothermal Actuator



645
液晶采暖温控器
LCD Air-conditioning
Thermostat



644
机械采暖温控器
Mechanical Air-conditioning
Thermostat



646
触控采暖温控器
Air-conditioning Thermostat
With Touch Screen



348
黄铜温控PPR手动调节阀
Brass Hand Temperature-
controlled Valve With PPR



711
黄铜组合式自动排气阀
Brass Automatic Combined-
type Exhausting Valve



712
黄铜快速定位自动排气阀
Brass Automatic Fast-
positioning Exhausting Valve



809 多功能球阀
Muti-Functional Valve



261 黄铜过滤球阀
Brass Filter Ball Valve (Q11F-16T)



801 三合一球阀
Three-in-one Ball valve



805 多功能球阀
Muti-Functional Valve



296 黄铜磁性球阀
Brass Magnetic Ball Valve
(Q11F-16T)



802 外丝活接四合一球阀
Lockable Multifunctional
Ball Valve, Union Nut, M/M



9206 多功能球阀
Muti-Functional Valve



331 静态平衡阀
Static Balanced Valve



258 黄铜测温球阀
Brass Temperature
Measured Ball Valve



282 暖气三通球阀
Brass 3-Way Ball Valve
(For Heated-air Use) (Q35F-16T)



259 黄铜锁式球阀
Brass Ball Valve With Lock



卓越精工, 自然出众!

PPR 阀门系列

PPR VALVES SERIES



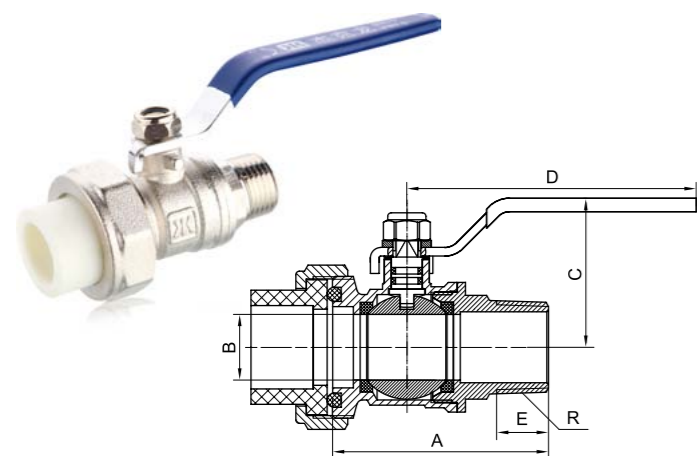

208 黄铜PPR球阀
Brass PPR Ball Valve (Q21F-16T)

技术规范 **Technical Standard**
公称压力: 1.6 MPa Nominal Pressure: 1.6 Mpa
工作介质: 水、非腐蚀性液体 Working Medium: Water, Non-causticity liquid
工作温度: $-10^{\circ}\text{C} \leq t \leq 120^{\circ}\text{C}$ Working Temperature: $-10^{\circ}\text{C} \leq t \leq 120^{\circ}\text{C}$
管螺纹符合ISO7/1标准 Taper Pipe Thread to ISO7/1

备注: 接头材质可选择PPR、PB、PERT

DN	Size	A	B	C	D	E	R
15	1/2	53.5	14	41.7	97.5	11.5	1/2
20	3/4	62.5	19	44.9	97.5	15	3/4
25	1	71.5	23.5	55.4	110	17	1
32	1 1/4	84	30	61.3	140	19	1 1/4

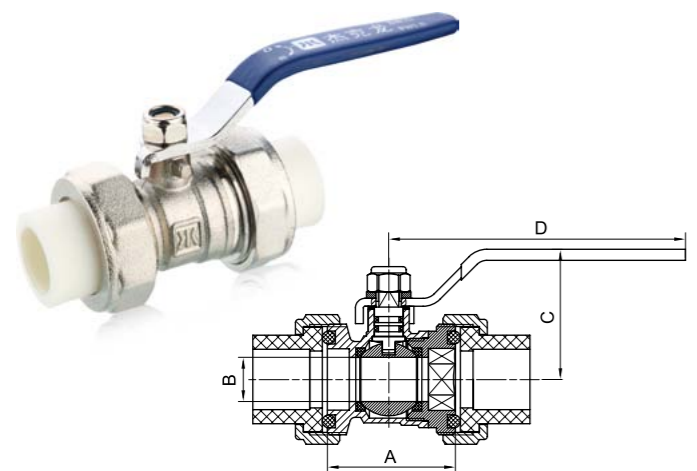

209 黄铜PPR球阀
Brass PPR Ball Valve (Q11F-16T)

技术规范 **Technical Standard**
公称压力: 1.6 MPa Nominal Pressure: 1.6 Mpa
工作介质: 水、非腐蚀性液体 Working Medium: Water, Non-causticity liquid
工作温度: $-10^{\circ}\text{C} \leq t \leq 120^{\circ}\text{C}$ Working Temperature: $-10^{\circ}\text{C} \leq t \leq 120^{\circ}\text{C}$

备注: 接头材质可选择PPR、PB、PERT

DN	Size	A	B	C	D
15	1/2	40.5	14	41.7	97.5
20	3/4	47	19	44.9	97.5
25	1	53	23.5	55.5	110
32	1 1/4	62	30	61	140
40	1 1/2	75.6	37	66	140
50	2	88	46.5	75	155

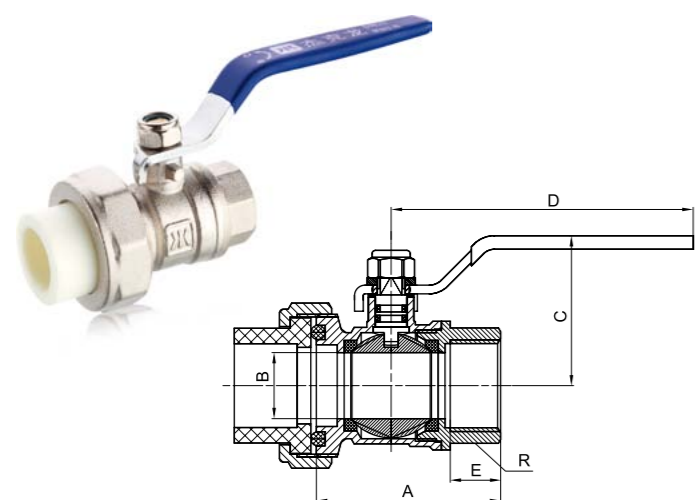

210 黄铜PPR球阀
Brass PPR Ball Valve (Q11F-16T)

技术规范 **Technical Standard**
公称压力: 1.6 MPa Nominal Pressure: 1.6 Mpa
工作介质: 水、非腐蚀性液体 Working Medium: Water, Non-causticity liquid
工作温度: $-10^{\circ}\text{C} \leq t \leq 120^{\circ}\text{C}$ Working Temperature: $-10^{\circ}\text{C} \leq t \leq 120^{\circ}\text{C}$

备注: 接头材质可选择PPR、PB、PERT

DN	Size	A	B	C	D	E	R
15	1/2	45.8	14	41.7	97.5	12.7	1/2
20	3/4	53	19	44.9	97.5	14.5	3/4
25	1	59.5	23.5	55.5	110	14	1

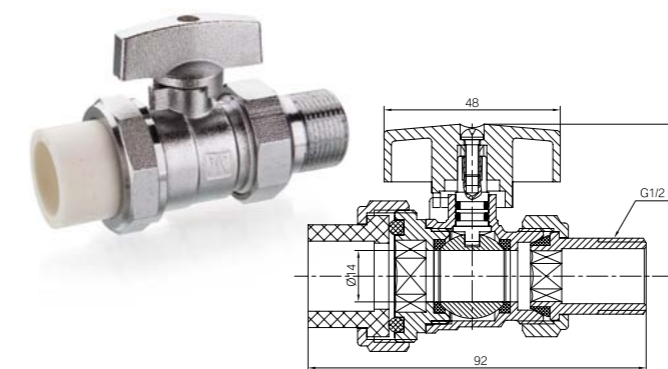

9208 黄铜外螺纹PPR双活接球阀
Brass PPR Ball Valve With Double Male Union

技术规范 **Technical Standard**
公称压力: 1.6 MPa Nominal Pressure: 1.6 Mpa
工作介质: 水、非腐蚀性液体 Working Medium: Water, Non-causticity liquid
工作温度: $-20^{\circ}\text{C} \leq t \leq 120^{\circ}\text{C}$ Working Temperature: $-20^{\circ}\text{C} \leq t \leq 120^{\circ}\text{C}$
圆锥管螺纹符合ISO7-1标准 Taper Pipe Thread to ISO7-1

备注: 接头材质可选择PPR、PB、PERT

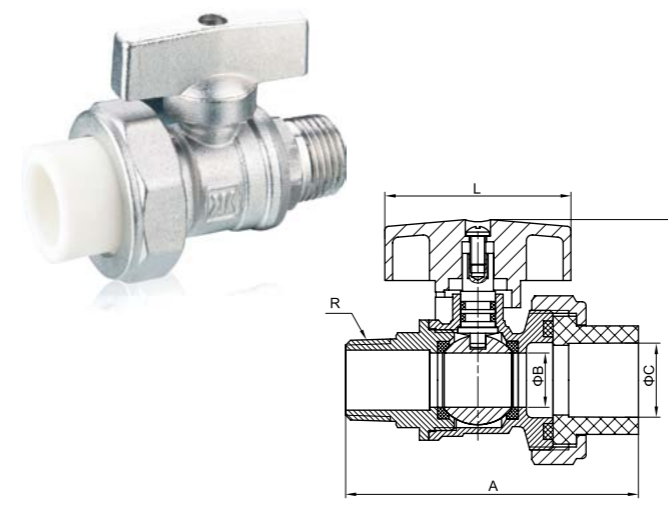

204 黄铜PB球阀
Brass PB Ball Valve (Q21F-16T)

技术规范 **Technical Standard**
公称压力: 1.6 MPa Nominal Pressure: 1.6 Mpa
工作介质: 水、非腐蚀性液体 Working Medium: Water, Non-causticity liquid
工作温度: $-10^{\circ}\text{C} \leq t \leq 120^{\circ}\text{C}$ Working Temperature: $-10^{\circ}\text{C} \leq t \leq 120^{\circ}\text{C}$
圆锥管螺纹符合ISO7-1标准 Taper Pipe Thread to ISO7-1

备注: 接头材质可选择PPR、PB、PERT

DN	A	B	C	H	L	R
15	75.5	14	19	41.4	48	1/2
20	84.5	19	24	44.6	48	3/4

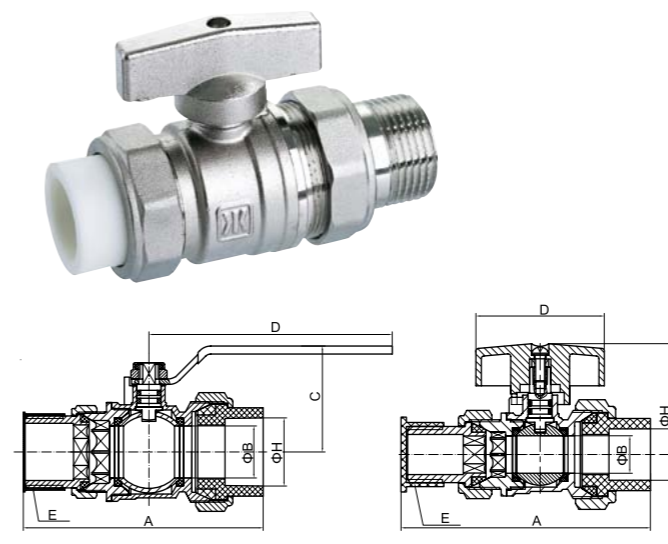

204A 黄铜活接PPR球阀
Brass PPR Ball Valve

技术规范 **Technical Standard**
公称压力: 1.6 MPa Nominal Pressure: 1.6 Mpa
工作介质: 水、非腐蚀性液体 Working Medium: Water, Non-causticity liquid
工作温度: $-20^{\circ}\text{C} \leq t \leq 100^{\circ}\text{C}$ Working Temperature: $-20^{\circ}\text{C} \leq t \leq 100^{\circ}\text{C}$
圆锥管螺纹符合ISO7-1标准 Taper Pipe Thread to ISO7-1

备注: 接头材质可选择PPR、PB、PERT

DN	A	B	C	D	E	H
1/2x20	93	14	41	48	G1/2	20
3/4x25	109	19	44.5	48	G3/4	25
1x25	115	19	54	60	G1	25
1x32	121	23.5	54	60	G1	32
1 1/4x40 (长手柄)	140	30	61	140	G1 1/4	40

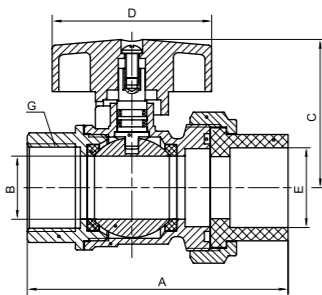

205 黄铜单活接头PPR球阀
Brass PPR Ball Valve With Female Union (Q11F-16T)

技术规范 **Technical Standard**
公称压力: 1.6 MPa Nominal Pressure: 1.6 Mpa
工作介质: 水、非腐蚀性液体 Working Medium: Water, Non-causticity liquid
工作温度: $-10^{\circ}\text{C} \leq t \leq 120^{\circ}\text{C}$ Working Temperature: $-10^{\circ}\text{C} \leq t \leq 120^{\circ}\text{C}$
圆柱管螺纹符合ISO228标准 Parallel Pipe Thread to ISO228

备注: 接头材质可选择PPR、PB、PERT

DN	Size	A	B	C	D	E	G
15	1/2	68	14	41.4	48	19.1	1/2
20	3/4	75	19	44.6	48	24	3/4

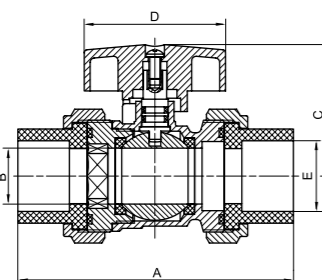

211 黄铜双活接头PPR球阀
Brass PPR Ball Valve With Double Female Union (Q11F-16T)

技术规范 **Technical Standard**
公称压力: 1.6 MPa Nominal Pressure: 1.6 Mpa
工作介质: 水、非腐蚀性液体 Working Medium: Water, Non-causticity liquid
工作温度: $-10^{\circ}\text{C} \leq t \leq 120^{\circ}\text{C}$ Working Temperature: $-10^{\circ}\text{C} \leq t \leq 120^{\circ}\text{C}$
圆柱管螺纹符合ISO228标准 Parallel Pipe Thread to ISO228

备注: 接头材质可选择PPR、PB、PERT

DN	Size	A	B	C	D	E
15	1/2	84.5	14	41.4	48	19.1
20	3/4	91	19	44.6	48	24

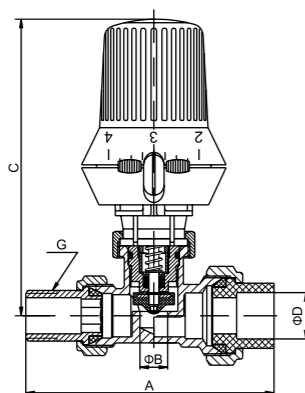

365 黄铜PPR自动温控阀
Brass PPR Automatic-controlled Radiator (J61W-16T)

技术规范 **Technical Standard**
公称压力: 1.6 MPa Nominal Pressure: 1.6 Mpa
工作介质: 水、饱和蒸汽 ($\leq 0.6\text{Mpa}$) Working Medium: Water, Saturated steam ($\leq 0.6\text{Mpa}$)
工作温度: $0^{\circ}\text{C} \leq t \leq 120^{\circ}\text{C}$ Working Temperature: $0^{\circ}\text{C} \leq t \leq 120^{\circ}\text{C}$
温控范围: $6^{\circ}\text{C} - 28^{\circ}\text{C}$ Temperature Range: $6^{\circ}\text{C} - 28^{\circ}\text{C}$
圆柱管螺纹符合ISO228标准 Parallel Pipe Thread to ISO228

备注: 接头材质可选择PPR、PB、PERT

DN	Size	A	B	C	D	G
15	1/2	103	12	122	19.2	1/2
20	3/4	113	13	122	24.1	3/4

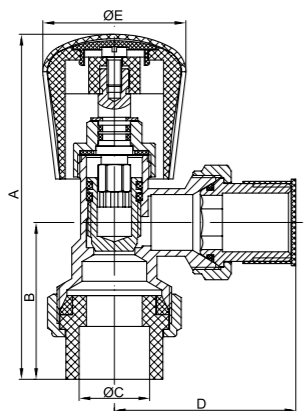

340 黄铜温控PPR手动调节阀
Brass Hand Temperature-controlled Valve With PPR (J64W-16T)

技术规范 **Technical Standard**
公称压力: 1.6 MPa Nominal Pressure: 1.6 Mpa
工作介质: 水、饱和蒸汽 ($\leq 0.6\text{Mpa}$) Working Medium: Water, Saturated steam ($\leq 0.6\text{Mpa}$)
工作温度: $-10^{\circ}\text{C} \leq t \leq 120^{\circ}\text{C}$ Working Temperature: $-10^{\circ}\text{C} \leq t \leq 120^{\circ}\text{C}$
圆柱管螺纹符合ISO228标准 Parallel Pipe Thread to ISO228

备注: 接头材质可选择PPR、PB、PERT

DN	A	B	C	D	E
15	109	45.5	19.2	59.5	41
20	121.5	53.5	24	62.5	48

锁式阀门系列

LOCKABLE VALVES SERIES



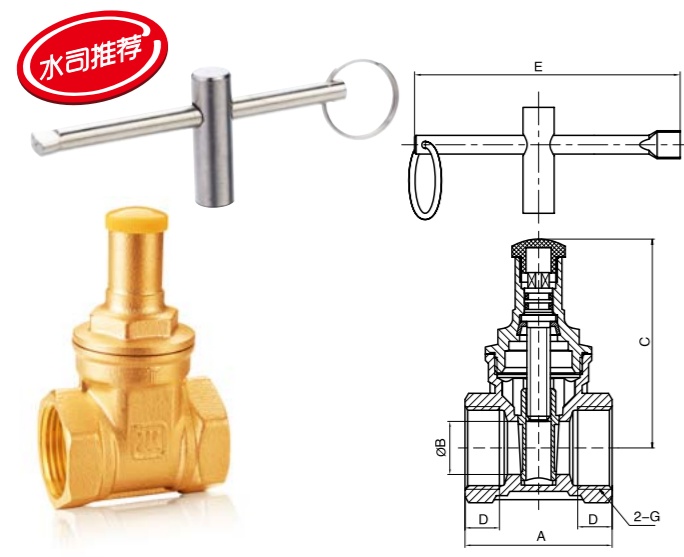

9118 黄铜锁式闸阀
Brass Lockable Gate Valve (Z15W-16T)

技术规范
公称压力: 1.6 MPa
工作介质: 水、非腐蚀性液体
工作温度: -10°C ≤ t ≤ 110°C
圆柱管螺纹符合ISO228标准

Technical Standard
Nominal Pressure: 1.6 MPa
Working Medium: Water, Non-causticity liquid
Working Temperature: -10°C ≤ t ≤ 110°C
Parallel Pipe Thread to ISO228

DN	A	B	C	D	E	G
15	43.5	13	62.3	10.5	75	1/2
20	47	17	66.8	11	75	3/4
25	52	21	75	13	75	1
32	57	27	87	13.5	75	1 1/4
40	60	34	98	14	120	1 1/2
50	67	45	115.6	15	120	2

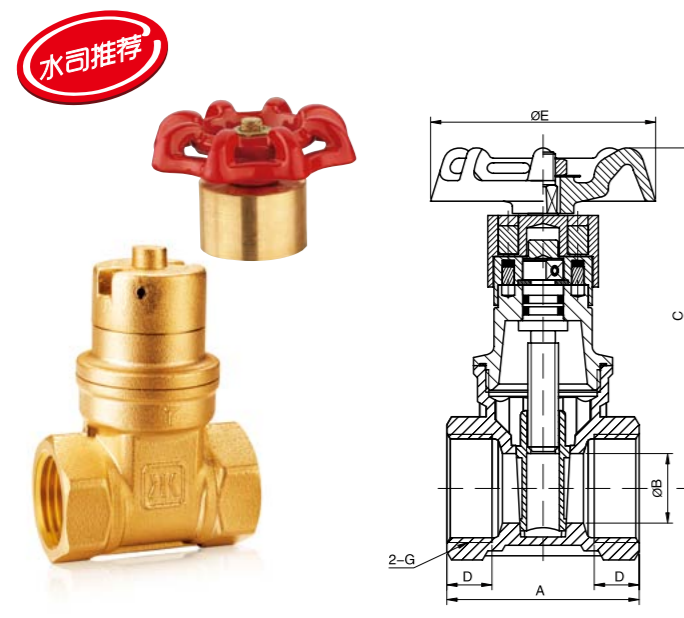

9119 黄铜磁性锁式闸阀
Brass Magnetic Lockable Gate Valve (Z15W-16T)

技术规范
公称压力: 1.6 MPa
工作介质: 水、非腐蚀性液体、饱和蒸汽(≤0.6MPa)
工作温度: -10°C ≤ t ≤ 110°C
圆柱管螺纹符合ISO228标准

Technical Standard
Nominal Pressure: 1.6 MPa
Working Medium: Water, Non-causticity liquid, Saturated steam(≤0.6MPa)
Working Temperature: -10°C ≤ t ≤ 110°C
Parallel Pipe Thread to ISO228

手轮

DN	A	B	C	D	E	G
15	43.5	13	75.5	10.5	54	1/2
20	47	17	83.2	11	54	3/4
25	52	21	90.2	13	54	1

长手柄锁

DN	A	B	C	D	G
32	57	27	77.5	13.5	1 1/4
40	60	34	90.3	14	1 1/2
50	67	45	108.8	15	2

114 黄铜表前磁性闸阀
Brass Magnetic Gate Valve Before Water Meter (Z15W-16T)

技术规范
公称压力: 1.6MPa
工作介质: 水、非腐蚀性液体
适用温度: t ≤ 150°C
圆柱管螺纹符合ISO228-1: 2000标准

Technical Standard
Nominal Pressure: 1.6MPa
Working Medium: Water, Non-causticity liquid
Working Temperature: t ≤ 150°C
Parallel Pipe Thread to ISO228-1:2000

DN	A	B	C	D	E	G
15X20	96.5-108.5	13	G3/4	54	75.5	G1/2
20X20	84-96	17.5	G3/4	54	83	G3/4
20X25	84.5-96.5	17.5	G1	54	83	G3/4
25X25	102-115.5	21	G1	54	90	G1

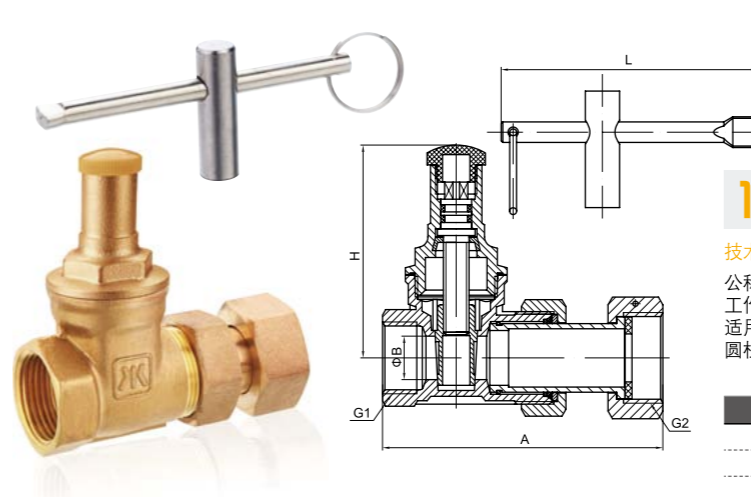

189 黄铜锁式伸缩闸阀
Brass Lockable Gate Valve With Expansion Joint (Z15W-16T)

技术规范
公称压力: 1.6MPa
工作介质: 水、非腐蚀性液体
适用温度: -10°C ≤ t ≤ 100°C
圆柱管螺纹符合ISO228-1

Technical Standard
Nominal Pressure: 1.6MPa
Working Medium: Water, Non-causticity liquid
Working Temperature: -10°C ≤ t ≤ 100°C
Parallel Pipe Thread to ISO228-1

DN	L	A	B	G1	G2	H
15x20	75	82-94	12.7	G1/2	G3/4	62
20x20	75	84-96	17.5	G3/4	G3/4	67
20x25	75	84.5-96.5	17.5	G3/4	G1	67

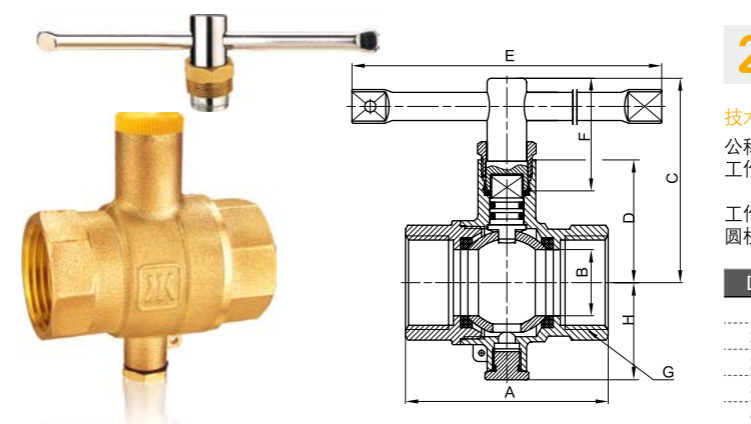

259 黄铜锁式球阀
Brass Ball Valve With Lock (Q11F-16T)

技术规范
公称压力: 1.6 MPa
工作介质: 水、非腐蚀性液体、饱和蒸汽(≤0.6MPa)
工作温度: -10°C ≤ t ≤ 100°C
圆柱管螺纹符合ISO228标准

Technical Standard
Nominal Pressure: 1.6 MPa
Working Medium: Water, Non-causticity liquid, Saturated steam(≤0.6MPa)
Working Temperature: -10°C ≤ t ≤ 100°C
Parallel Pipe Thread to ISO228

DN	A	B	C	D	E	F	G	H
15	53	12.5	55.5	34.3	84	32	1/2	34.5
20	57.5	15	57.5	36.3	84	32	3/4	33.5
25	72	23.5	72.6	43.6	160	40	1	34.5
32	80	30	77.8	48.8	160	40	1 1/4	39.5
40	90.6	37	89.3	56	160	45	1 1/2	45

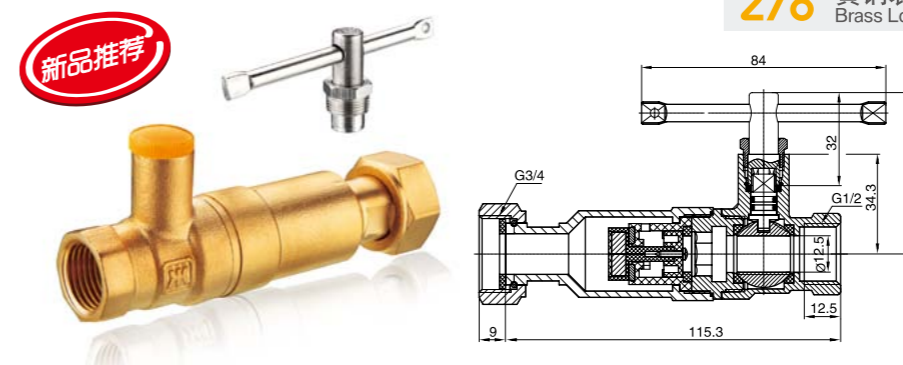

278 黄铜表前锁式止回球阀
Brass Lockable Check Valve Before Water Meter (Q11F-16T)

技术规范
公称压力: 1.6 MPa
工作介质: 水
工作温度: t ≤ 80°C
圆柱管螺纹符合ISO228标准

Technical Standard
Nominal Pressure: 1.6 Mpa
Working Medium: Water
Working Temperature: t ≤ 80°C
Parallel Pipe Thread to ISO228

279 黄铜锁式球阀
Brass Ball Valve With Lock (Q11F-16T)

技术规范
公称压力: 1.6 MPa
工作介质: 水、非腐蚀性液体
工作温度: -10°C ≤ t ≤ 100°C
圆柱管螺纹符合ISO228标准

Technical Standard
Nominal Pressure: 1.6 Mpa
Working Medium: Water, Non-causticity liquid
Working Temperature: -10°C ≤ t ≤ 100°C
Parallel Pipe Thread to ISO228

DN	A	B	C	D	E	F	G
15	53	12.5	55.5	34.3	84	32	1/2
20	57.5	15	57.5	36.3	84	32	3/4
25	72	23.5	72.6	43.6	160	40	1
32	80	30	77.8	48.8	160	40	1 1/4
40	90.6	37	89.3	56	160	45	1 1/2
50	106	46.5	96.5	63.3	160	45	2

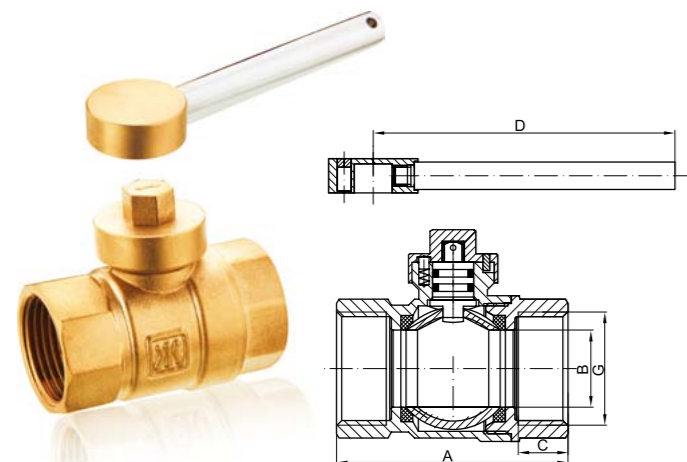

296 黄铜磁性球阀
Brass Magnetic Ball Valve (Q11F-16T)

技术规范 公称压力: 1.6 MPa
工作介质: 水
工作温度: -10°C ≤ t ≤ 100°C
圆柱管螺纹符合ISO228-1: 2000标准

Technical Standard Nominal Pressure: 1.6 Mpa
Working Medium: Water
Working Temperature: -10°C ≤ t ≤ 100°C
Parallel Pipe Thread to ISO228-1:2000

DN	A	B	C	D	G
15	52.5	14	12	88	1/2
20	56.5	18	12	88	3/4
25	67.5	22.5	14.5	88	1
32	79	28	15.5	90.5	1 1/4

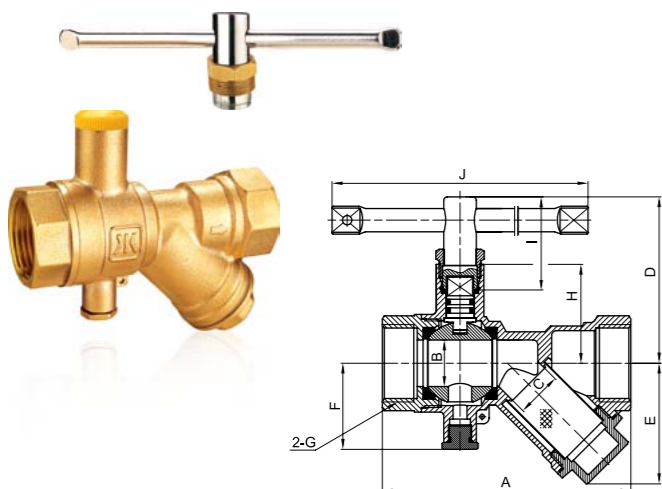

801 三合一球阀
Brass Ball Valve (Q11F-16T)

技术规范 公称压力: 1.6 MPa
工作介质: 水、非腐蚀性液体、饱和蒸汽(≤0.6MPa)
工作温度: -10°C ≤ t ≤ 110°C
圆柱管螺纹符合ISO228标准

Technical Standard Nominal Pressure: 1.6 Mpa
Working Medium: Water, Non-causticity liquid, Saturated steam(≤0.6MPa)
Working Temperature: -10°C ≤ t ≤ 110°C
Parallel Pipe Thread to ISO228

DN	A	B	C	D	E	F	G	H	I	J	过滤网目数
20	89.6	15	14.5	57.5	41.8	33.5	3/4	36.3	32	84	24X24
25	106.8	20	19.5	71.5	51.8	37	1	42.5	40	160	24X24
32	128.5	30	25	77.8	63.8	39.5	1 1/4	48.8	40	160	12X9

9277A 黄铜磁控防盗球阀
Brass Magnetic Anti-Theft Ball Valve (RQL-PN16)

- 产品特点:**
1. 主要零件采用优质铜材 (HPb59-1) 和热锻工艺制作而成, 使产品具有良好的机械物理性能。
 2. 采用优质氟塑料 (PTFE) 作为密封材料, 保证产品无泄漏, 并有较高的使用寿命。
 3. 当处于管理模式状态下, 用户无法开关燃气阀, 只有燃气公司通过专用钥匙才能开关燃气阀, 真正实现有效管控。

技术规范 公称压力: 1.6 MPa
工作介质: 天然气、人工煤气、液化石油气
工作温度: -20°C ≤ t ≤ 80°C
圆柱管螺纹符合ISO228标准

Technical Standard Nominal Pressure: 1.6 Mpa
Working Medium: Natural gas, Artificial gas, Liquefied petroleum gas
Working Temperature: -20°C ≤ t ≤ 80°C
Parallel Pipe Thread to ISO228

DN	A	B	C	D	E	F
15	57	14	G1/2	41	50	54
20	67	19	G3/4	44	50	54
25	78.6	24	G1	50	50	54

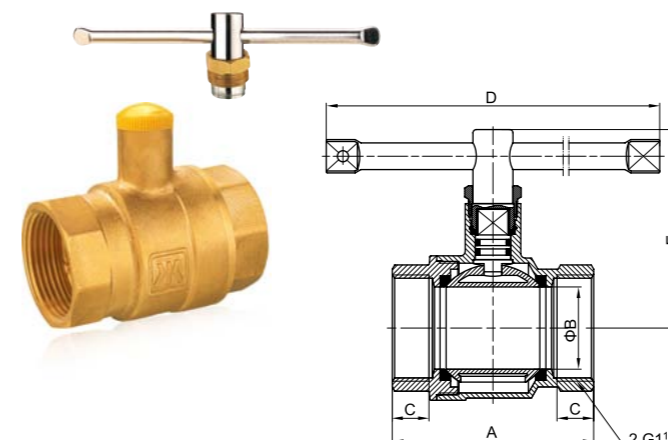

280 黄铜燃气锁式球阀
Lockable Brass Gas Ball Valve (Q11F-16T)

技术规范 公称压力: 1.6 MPa
工作介质: 天然气、人工煤气、液化石油气
工作温度: -20°C ≤ t ≤ 110°C
圆柱管螺纹符合ISO228-1: 2000标准

Technical Standard Nominal Pressure: 1.6 Mpa
Working Medium: Natural gas, Artificial gas, Liquefied petroleum gas
Working Temperature: -20°C ≤ t ≤ 110°C
Parallel Pipe Thread to ISO228-1:2000

DN	A	B	C	D	E	G
40	90.6	37	16.5	160	89.3	1 1/2
50	106	46.5	18	160	96.5	2

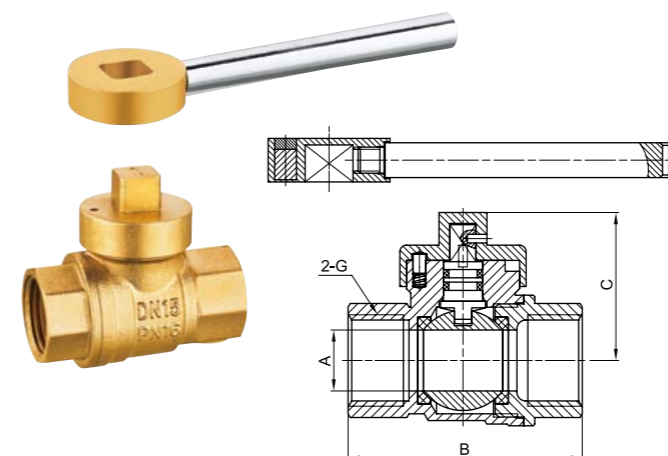

289 黄铜磁性锁式球阀
Brass Magnetic Lockable Ball Valve (Q11F-16T)

技术规范 公称压力: 1.6 MPa
工作介质: 水
工作温度: -10°C ≤ t ≤ 100°C
圆柱管螺纹符合ISO228标准

Technical Standard Nominal Pressure: 1.6 Mpa
Working Medium: Water
Working Temperature: -10°C ≤ t ≤ 100°C
Parallel Pipe Thread to ISO228

DN	SIZE	A	B	C	G
15	1/2	14	53.8	34.5	1/2
20	3/4	19	63	36.2	3/4
25	1	23.5	72	41.9	1

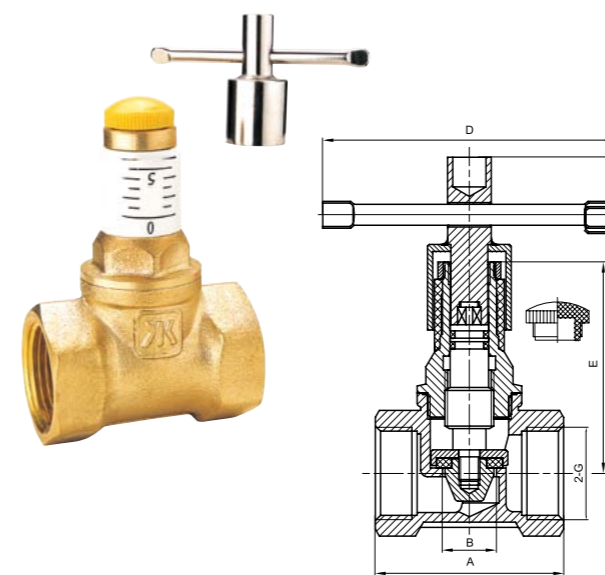

383 黄铜带刻度锁式调节阀
Brass Lockable Adjustable Valve (J11W-16T)

技术规范 公称压力: 1.6 MPa
工作介质: 水、非腐蚀性液体
工作温度: -10°C ≤ t ≤ 100°C
圆柱管螺纹符合ISO228标准

Technical Standard Nominal Pressure: 1.6 Mpa
Working Medium: Water, Non-causticity liquid
Working Temperature: -10°C ≤ t ≤ 100°C
Parallel Pipe Thread to ISO228

DN	SIZE	A	B	C	D	E	G
20	3/4	54	15.5	90.5	84	60.5	3/4
25	1	64	18.5	95.3	84	67.3	1
32	1 1/4	75	24	99.3	84	71.3	1 1/4

法兰系列 FLANGED VALVES SERIES

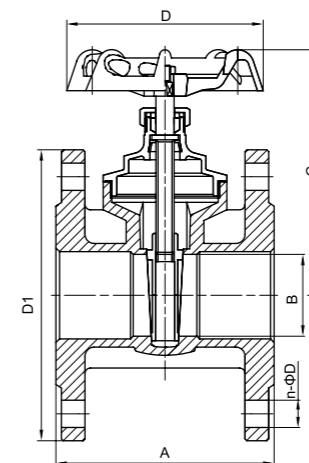

106 黄铜法兰闸阀 Brass Flanged Gate Valve (Z45W-16T)

技术规范
公称压力: 1.6 MPa
工作介质: 水、非腐蚀性液体、饱和蒸汽(≤0.6MPa)
工作温度: -20℃≤t≤150℃

Technical Standard
Nominal Pressure: 1.6 Mpa
Working Medium: Water, Non-causticity liquid, Saturated steam(≤0.6MPa)
Working Temperature: -20℃≤t≤150℃

DN	A	B	C	D	D1	ΦD	n
15	79.5	15	78.5	60	90	14	4
20	88.5	20	88.5	60	100	14	4
25	98.5	25	97.5	60	110	14	4
32	108.5	32	124.3	80	132	18	4
40	118	38	137.5	80	143	18	4
50	116	45	136.5	108	158	18	4
65	137	55.5	166	126	178	18	4
80	157	67.5	196.5	179	193	18	8
100	178	90	239.5	200	213	18	8

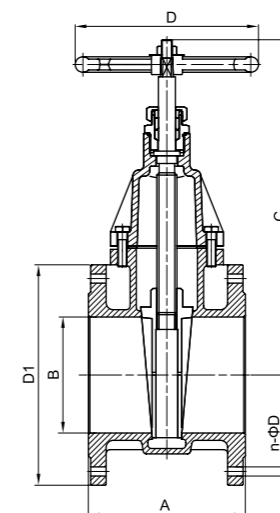

106 黄铜法兰闸阀 Brass Flanged Gate Valve (Z45W-16T)

技术规范
公称压力: 1.6 MPa
工作介质: 水、非腐蚀性液体、饱和蒸汽(≤0.6MPa)
工作温度: -20℃≤t≤150℃

Technical Standard
Nominal Pressure: 1.6 Mpa
Working Medium: Water, Non-causticity liquid, Saturated steam(≤0.6MPa)
Working Temperature: -20℃≤t≤150℃

DN	A	B	C	D	D1	ΦD	n
125	178	125	381.5	237	245	18	8
150	201	150	433.5	237	280	22	8
200	247.5	200	553.5	320	335	22	8

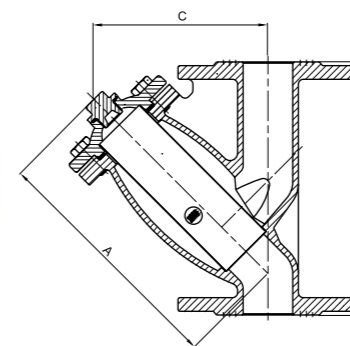

603 黄铜法兰过滤器 Brass Flanged Strainer (WF41B-16T)

技术规范
公称压力: 1.6 MPa
工作介质: 水
工作温度: 0℃≤t≤100℃

Technical Standard
Nominal Pressure: 1.6 Mpa
Working Medium: Water
Working Temperature: 0℃≤t≤100℃

DN	A	B	C	n	ΦD
15	48	118	45	4	14
20	59	128	56	4	14
25	71	141	50	4	14
32	94.5	173	67	4	18
40	195.5	202	138	4	18
50	219	242	154.5	4	18
65	251	277	177.5	4	18
80	284	303	201	8	18
100	322	356	227.4	8	18

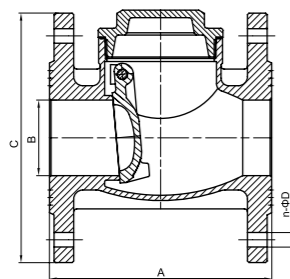

409 黄铜法兰止回阀
Brass Flanged Check Valve (H44W-16T)

技术规范 **Technical Standard**
公称压力: 1.6 MPa Nominal Pressure: 1.6 Mpa
工作介质: 水、非腐蚀性液体、饱和蒸汽(≤0.6Mpa) Working Medium: Water, Non-causticity Liquid Saturated steam(≤0.6Mpa)
工作温度: t≤150℃ Working Temperature: t≤150℃

DN	A	B	C	ΦD	n
40	134	40	143	18	4
50	143	50	158	18	4
65	160	65	178	18	4
80	185	80	193	18	8
100	214	100	213	18	8

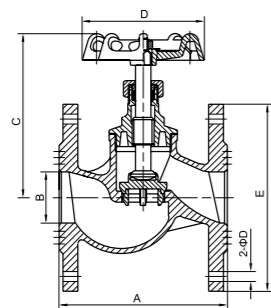

314 黄铜法兰截止阀
Brass Flanged Stop Valve (J41W-16T)

技术规范 **Technical Standard**
公称压力: 1.6 MPa Nominal Pressure: 1.6 Mpa
工作介质: 水、非腐蚀性液体、饱和蒸汽(≤0.6Mpa) Working Medium: Water, Non-causticity Liquid Saturated steam(≤0.6Mpa)
工作温度: -20℃≤t≤150℃ Working Temperature: -20℃≤t≤150℃

DN	A	B	C	D	E	n	ΦD
15	80	15	79-84	54	90	4	14
20	87	20	87-94	60	100	4	14
25	98	25	94-101	72	110	4	14
32	108	32	114-125.5	80	132	4	18
40	133	41	132-142	100	143	4	18
50	211	50	182	125	158	4	18
65	233	63	194-220	179	177	4	18
80	301	79	290-319	200	193	8	18
100	320	102	338-403	236	213	8	18

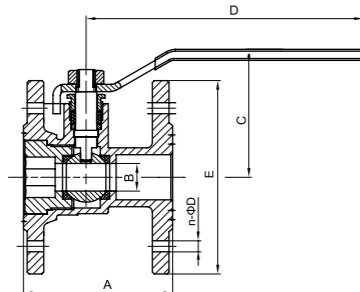
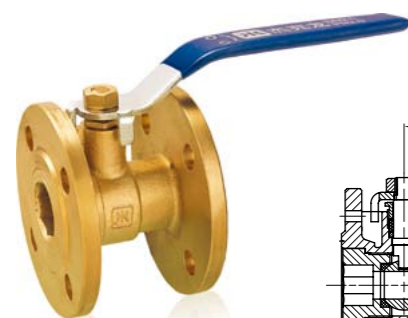

240 黄铜法兰球阀
Brass Flanged Ball Valve (Q41F-16T)

技术规范 **Technical Standard**
公称压力: 1.6 MPa Nominal Pressure: 1.6 Mpa
工作介质: 水、非腐蚀性液体、饱和蒸汽(≤0.6Mpa) Working Medium: Water, Non-causticity liquid, Saturated steam(≤0.6Mpa)
工作温度: -20℃≤t≤120℃ Working Temperature: -20℃≤t≤120℃
圆柱管螺纹符合ISO228标准 Parallel Pipe Thread to ISO228

DN	A	B	C	D	E	ΦD	n
15	78	12	74	157.5	90	14	4
20	78	15	69	157.5	100	14	4
25	81	20	74	157.5	110	14	4
32	87	25	85.5	167.5	132	18	4
40	102	32	93.7	185.9	143	18	4
50	101	40	105.3	185.9	158	18	4
65	104	50	125.5	215	178	18	8
80	124	65	134.8	218.9	193	18	8
100	136	80	151.8	219	213	18	8

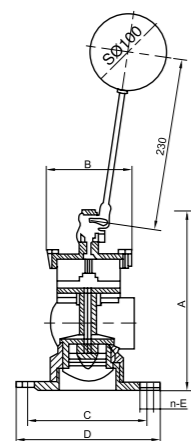

902 法兰浮球阀
Floating Ball Actuated Flanged Valve (KXF-6T-A)

技术规范 **Technical Standard**
公称压力: 0.04 MPa≤P≤0.6MPa Nominal Pressure: 0.04 MPa≤P≤0.6MPa
工作介质: 水 Working Medium: Water
工作温度: 0℃≤t≤120℃ Working Temperature: 0℃≤t≤120℃
联接方式: 法兰 Connecting From: Flange

DN	Size	A	B	C	D	n	E
40	1 1/2	164	63	110	145	4	18
50	2	178	63	125	160	4	18
65	2 1/2	210	112	145	180	4	18
80	3	236	117	160	195	4	18
100	4	262	130	180	215	8	18
150	6	270	159	240	280	8	23
200	8	330	211	295	335	8	23
250	10	520	350	350	390	12	23
300	12	600	425	400	440	12	23

小五金系列
HARDWARE SERIES





708-L 水嘴
Bibcock



219 黄铜直角球阀(球芯三角阀)
Brass Right Angle Ball Valve (Q24F-16T)



501 黄铜球芯水咀
Brass Ball Core Tap



S710 水嘴
Bibcock



S705 水嘴(洗衣机)
Bibcock for Washing Machine



S708 水嘴
Bibcock



SJ-805 陶瓷三角阀
Ceramic Triangle Valve



SJ-806 陶瓷三角阀
Ceramic Triangle Valve



407 地漏
Floor Drain



411 地漏
Floor Drain



412 地漏
Floor Drain



翻板下水
Po-plug



不锈钢编织管
Stainless Braided Hose



波纹管
Wave Hose

水表系列 WATER METERS SERIES





旋翼式立式水表
Rotary vertical water meter
/LXSL-15E~25E

- ◆ 特点 Feature
各种性能和计量精度达到ISO 4064 2级标准;
Various performance and measuring accuracy meet the standard of ISO 4064 2;
垂直安装, 具有安装方便, 节省材料, 泥沙不易侵入等优点。
Easy vertical installation, material saving, against sediment invasion.
- ◆ 使用条件 Conditions of usage
水温 $\leq 30^{\circ}\text{C}$, 水压 $\leq 1\text{MPa}$
Water temperature $\leq 30^{\circ}\text{C}$, Water pressure $\leq 1\text{MPa}$
- ◆ 最大允许误差 Maximum permissible tolerance
从最小流量(包括 Q_1)到分界流量(不包括 Q_2)的低区为 $\pm 5\%$
 $\pm 5\%$ From minimum flow (including Q_1) to transitional flow (excluding Q_2)
从分界流量(包括 Q_2)到过载流量(包括 Q_4)的高区为 $\pm 2\%$
 $\pm 2\%$ From transitional flow (including Q_2) to overload flow (including Q_4)

性能误差曲线 Performance tolerance curve

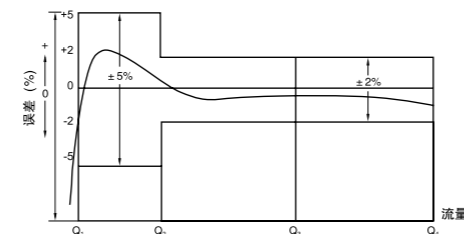

压力损失曲线 Pressure loss curve

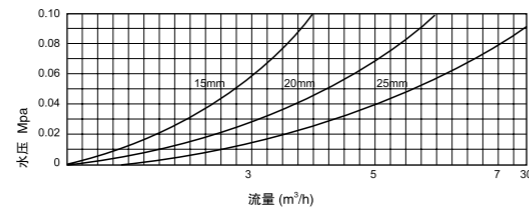

主要技术参数 Technical Specifications

公称口径 DN(mm)	最小流量 (L/h)	分界流量 (L/h)	常用流量 (m³/h)	过载流量 (m³/h)	Q_3/Q_1
15	50	80	2.5	3.125	50
	40	64			63
	31	50			80
20	80	128	4	5	50
	63	101			63
	50	80			80
25	126	202	6.3	7.875	50
	100	160			63
	79	126			80

外型尺寸及重量 Dimension & Weight

型号	口径 (mm)	长 L (mm)	宽 B1 (mm)	宽 B2 (mm)	高 H (mm)	连接螺纹 (D)	重量 (kg)
LXSL-15E	15	96	96	142	107	G 3/4B	1.7
LXSL-20E	20	100	96	157	109	G 1B	2.1
LXSL-25E	25	110	103	162	111	G 1 1/4B	3.1



旋翼式干式水表
Rotary dry type water meter
/LXSG-15E~50E

- ◆ 特点 Feature
各种性能和计量精度达到ISO 4064 2级标准;
Various performance and measuring accuracy meet the standard of ISO 4064 2;
多流束、干式、磁性传动;
Multi-jet, Dry-type, Magnetic transmission
计数器采用真空密封, 防冷凝雾化, 可长期保持读数清晰。
The counter adopts vacuum seal & anti-condensate atomization, providing clear reading for long time.
- ◆ 使用条件 Conditions of usage
水温 $\leq 30^{\circ}\text{C}$, 水压 $\leq 1\text{MPa}$
Water temperature $\leq 30^{\circ}\text{C}$, Water pressure $\leq 1\text{MPa}$
- ◆ 最大允许误差 Maximum permissible tolerance
从最小流量(包括 Q_1)到分界流量(不包括 Q_2)的低区为 $\pm 5\%$
 $\pm 5\%$ From minimum flow (including Q_1) to transitional flow (excluding Q_2)
从分界流量(包括 Q_2)到过载流量(包括 Q_4)的高区为 $\pm 2\%$
 $\pm 2\%$ From transitional flow (including Q_2) to overload flow (including Q_4)

主要技术参数 Technical Specifications

公称口径 DN(mm)	最小流量 (L/h)	分界流量 (L/h)	常用流量 (m³/h)	过载流量 (m³/h)	Q_3/Q_1	Q_4/Q_3	Q_2/Q_1
15	50	80	2.5	3.125	50	1.25	1.6
	40	64			63		
	31	50			80		
20	80	128	4	5	50		
	63	101			63		
	50	80			80		
25	126	202	6.3	7.875	50		
	100	160			63		
	79	126			80		
32	200	320	10	12.5	50		
	159	254			63		
	125	200			80		
40	320	512	16	20	50		
	254	406			63		
	200	320			80		
50	500	800	25	31.25	50		
	397	635			63		
	313	501			80		

外型尺寸及重量 Dimension & Weight

型号	口径 (mm)	长 L (mm)	宽 B (mm)	高 H (mm)	连接螺纹 (D)	重量 (kg)
LXSG-15E	15	165	99	104	G 3/4B	1.5
LXSG-20E	20	195	99	106	G 1B	1.7
LXSG-25E	25	225	104	120	G 1 1/4B	2.4
LXSG-32E	32	230	104	120	G 1 1/2B	2.8
LXSG-40E	40	245	125	155	G 2B	5.1
LXSG-50E	50	280	158	175	法兰连接按GB42164-84 Connecting flange conform to GB42164-84	14



旋翼式湿式冷水表/LXS-15E~50E
Rotary wet-type cold water meter

- ◆ 特点 Feature
具有计量精度高、始动流量小, 能保持计数机构的满灌(充满水), 防污性好、抄读方便、外形美观、安全卫生、寿命长等特点。
High measurement accuracy, small starting flow, keep the counting facility filled with water, anti-fouling, easy reading, nice appearance, safety and health, reliable quality.
- ◆ 使用温度 常温: $0 \sim 30^{\circ}\text{C}$
Temperature of usage: Normal temperature $0 \sim 30^{\circ}\text{C}$
- ◆ 公称压力 $\leq 1.0\text{MPa}$ Nominal pressure $\leq 1.0\text{MPa}$
- ◆ 压力损失 $\leq 0.063\text{MPa}$ Pressure loss $\leq 0.063\text{MPa}$
- ◆ 示值误差限 Indication tolerance
在水温 0.1°C 至 30°C 范围内, 水表的允许误差在高区($Q_2 \leq Q \leq Q_4$)为 $\pm 2\%$, 低区($Q_1 \leq Q < Q_2$)为 $\pm 5\%$ 。
Range from 0.1°C to 30°C , the maximum permissible tolerance is $\pm 2\%$ in high limits ($Q_2 \leq Q \leq Q_4$), and $\pm 5\%$ in low limits ($Q_1 \leq Q < Q_2$).

主要技术参数 Technical Specifications

公称口径 DN(mm)	最小流量 (L/h)	分界流量 (L/h)	常用流量 (m³/h)	过载流量 (m³/h)	Q_3/Q_1	Q_4/Q_3	Q_2/Q_1
15	50	80	2.5	3.125	50	1.25	1.6
	40	64			63		
	31	50			80		
20	80	128	4	5	50		
	63	101			63		
	50	80			80		
25	126	202	6.3	7.875	50		
	100	160			63		
	79	126			80		
32	200	320	10	12.5	50		
	159	254			63		
	125	200			80		
40	320	512	16	20	50		
	254	406			63		
	200	320			80		
50	500	800	25	31.25	50		
	397	635			63		
	313	501			80		

(旋翼式湿式冷水表)外型尺寸及重量 (Rotary wet-type cold water meter) Dimension & Weight

型号	口径 (mm)	长 L (mm)	宽 B (mm)	高 H (mm)	连接螺纹 (D)	重量 (kg)
LXS-15E	15	165	99	104	G 3/4B	1.5
LXS-20E	20	195	99	106	G 1B	1.7
LXS-25E	25	225	104	120	G 1 1/4B	2.4
LXS-32E	32	230	104	120	G 1 1/2B	2.8
LXS-40E	40	245	125	155	G 2B	5.1
LXS-50E	50	280	158	175	法兰连接按GB42164-84	14

(旋翼式热水表)外型尺寸及重量 (Rotary hot water meter) Dimension & Weight

型号	口径 (mm)	长 L (mm)	宽 B (mm)	高 H (mm)	连接螺纹 (D)	重量 (kg)
LXSR-15E	15	165	99	104	G 3/4B	1.5
LXSR-20E	20	195	99	106	G 1B	1.7
LXSR-25E	25	225	104	120	G 1 1/4B	2.4
LXSR-32E	32	230	104	120	G 1 1/2B	2.8
LXSR-40E	40	245	125	155	G 2B	5.1



旋翼式热水表/LXSR-15E~40E
Rotary hot water meter

- ◆ 特点 Feature
各种性能和计量精度达到ISO 4064 2级标准;
Various performance and measurement accuracy meet the standard of ISO 4064 B.
- ◆ 用途 Application
用于计量流经管道的热水体积的总量。
For counting the total volume of hot water flowing through the pipelines.
- ◆ 使用温度 $\leq 90^{\circ}\text{C}$ Temperature of usage $\leq 90^{\circ}\text{C}$
- ◆ 公称压力 $\leq 1.0\text{MPa}$ Nominal pressure $\leq 1.0\text{MPa}$
- ◆ 压力损失 $\leq 0.1\text{MPa}$ Pressure loss $\leq 0.1\text{MPa}$
- ◆ 示值误差限 Indication tolerance
水温超过 30°C 时, 水表在高区的最大允许误差($Q_1 \leq Q \leq Q_3$)为 $\pm 3\%$, 低区($Q_{\min} \leq Q < Q_1$)为 $\pm 5\%$ 。
When the water temperature exceeds 30°C , the maximum permissible tolerance is $\pm 3\%$ in high limits ($Q_1 \leq Q \leq Q_3$), and $\pm 5\%$ in low limits ($Q_{\min} \leq Q < Q_1$).

主要技术参数 Technical Specifications

水表 代号	公称口径 DN(mm)	计量等级	标准流量点(m³/h)			
			最小流量 Q_{\min}	分界流量 Q_1	常用流量 Q_2	过载流量 Q_3
N1.5	15	B级	0.03	0.12	1.5	3
N2.5	20	B级	0.05	0.2	2.5	5
N3.5	25	B级	0.07	0.28	3.5	7
N6	32	B级	0.12	0.48	6	12
N10	40	B级	0.2	0.8	10	20



旋翼式液封水表(带止回阀)/LXSY-15E~25E
Rotary hydraulic sealing water meter (with check valve)

◇ 特点 Feature

- 1、本系列分为半液封和全液封两种，其计数机构字轮及表面由特殊液体封装，同时具有湿式水表始动流量小，干式水表可长期保持读书清晰的优点，也不受水质影响，永久保持读书清晰，特别适用于水质较差的管网。
1、This series includes semi-liquid seal and liquid seal. The digital facility and surface sealed by special liquid, enjoying the advantage of small starting flow and clear reading for long term, avoiding affection of water quality, especially for pipe network with poor water quality.
- 2、进水端采用止回阀结构，倒装不能正常用水，能够防止倒流。
2、The water inlet adopts the structure of check valve, prevents backflow.
- 3、该水表灵敏度极高，能起到节水、滴水计量的作用。
3、High sensitivity, save water, meter by drop of water.

- ◇ 使用温度 常温: 0~30℃
Temperature of usage: Normal temperature 0~30℃

- ◇ 公称压力 ≤1.0MPa Nominal pressure ≤1.0 MPa

- ◇ 压力损失 ≤0.063MPa Pressure loss ≤0.063 MPa

- ◇ 示值误差限 Indication tolerance

在水温0.1℃至30℃范围内，水表的允许误差在高区 ($Q_1 \leq Q \leq Q_4$) 为 ±2%，低区 ($Q_1 \leq Q \leq Q_2$) 为 ±5%
Range from 0.1℃ to 30℃, the maximum permissible tolerance is ±2% in high limits ($Q_2 \leq Q \leq Q_4$), and ±5% in low limits ($Q_1 \leq Q \leq Q_2$).

主要技术参数 旋翼式液封水表(带止回阀)

Technical Specifications Rotary hydraulic sealing water meter (with check valve)

公称口径 DN (mm)	最小流量 Q_1 (L/h)	分界流量 Q_2 (L/h)	常用流量 Q_3 (m³/h)	过载流量 Q_4 (m³/h)	标准流量点 (m³/h)		最大读数 (m³)
					Q_3 / Q_1	Q_2 / Q_1	
15	50	80	2.5	3.125	50	0.0001	99999
	31	50			80		
	25	40			100		
20	80	128	4.0	5.0	50	0.0001	99999
	50	80			80		
	40	64			100		

(旋翼式液封水表)外型尺寸及重量

(Rotary hydraulic sealing water meter) Dimension & Weight

型号	口径 (mm)	长 L (mm)	宽 B (mm)	高 H (mm)	连接螺纹 (D)	重量 (Kg)
LXSY-15E	15	165	99	109	G 3/4B	1.5
LXSY-20E	20	195	99	111	G 1B	1.7
LXSY-25E	25	225	104	120	G 1 1/4B	2.4

(水平螺翼式湿式冷(热)水表)外型尺寸及重量

Level screw wing- wet cold (hot) water meter Dimension & Weight

型号	口径 (mm)	长 L (mm)	高 H (mm)	连接法兰			重量 (Kg)
				法兰外径 (mm)	螺栓孔中心圆直径 (mm)	连接螺栓数量 (pcs.)	
LXL-80E	80	223	228	195	160	8XM16	14
LXL-100E	100	250	244	215	180	8XM16	16.5
LXL-150E	150	300	295	280	238	8XM20	28
LXL-200E	200	350	366	340	283	8XM20	42



水平螺翼式湿式冷(热)水表/LXL(R)-80E~200E
Level screw wing- wet cold (hot) water meter

◇ 特点 Feature

- 各项技术指标符合ISO 4064 2级标准(热水表为A级)
计数器为指针加字轮组合 (E型);
有冷、热水表 (R型) 可供客户选择;
结构简单、先进、价格低;
流通能力大、压力损失小
The technical specifications meet the standard of ISO 4064 2 (A level for hot water meter);
The counter is a combination of pointer-plus-word round (E type);
Cold or hot water meter (R type) for your choice;
Simple structure and competitive price.
High flow capacity and low pressure loss.

◇ 使用条件 Conditions of usage

使用温度: 0.1℃ ≤ T ≤ 30℃ (热水表 30℃ ≤ T ≤ 90℃)
Water temperature 0.1℃ ≤ T ≤ 30℃ (Hot water meter 30℃ ≤ T ≤ 90℃)
公称压力: 1.0Mpa
Nominal pressure: 1.0 MPa

◇ 最大允许误差 Maximum permissible tolerance

从最小流量(包括 Q_1 或 Q_{min})到分界流量(不包括 Q_2 或 Q_1)的低区为 ±5%
±5% From minimum flow (including Q_1 / Q_{min}) to transitional flow (excluding Q_2 / Q_1)
从分界流量(包括 Q_2 或 Q_1)到过载流量(包括 Q_4 或 Q_3)的高区为 ±2%
±2% From transitional flow (including Q_2 / Q_1) to overload flow (including Q_4 / Q_3)

主要技术参数 (水平螺翼式湿式热水表)

Technical Specifications Level screw wing- wet hot water meter

公称口径 DN(mm)	计量等级	标准流量点 (m³/h)			
		最小流量 Q_{min}	分界流量 Q_1	常用流量 Q_3	过载流量 Q_4
80	A级	3.2	12	40	80
100	A级	4.8	18	60	120
150	A级	12	45	150	300
200	A级	20	75	250	500

主要技术参数 (水平螺翼式湿式冷水表)

Technical Specifications Level screw wing- wet cold water meter

公称口径 DN(mm)	过载流量	常用流量	分界流量	最小流量	标准流量点 (m³/h)		量比 Q_3 / Q_1
					Q_4 / Q_3	Q_2 / Q_1	
80	78.75	63	10	2.52	12.6	3.15	25
					16	4	
100	125	100	20	5	40	10	20
					50	12.5	
150	312.5	250	64	16	80	20	25
					80	20	

给排水阀门系列

WATER SUPPLY & DRAINAGE VALVES SERIES



闸阀系列
GATE VALVE SERIES



1101
弹性座封闸阀
Resilient-seated Gate Valve
(Z45X)



1103
带传动弹性座封闸阀
Elastic-Seat Enclosed Gate Valve
(Z45X)



1105
明杆弹性座封闸阀
Soft Sealing Gate Valve
(Z41X)



1149
磁性锁式弹性座封闸阀
Magnetic Locking Resilient-
Seated Gate Valve (Z45X)



1168
丝口弹性座封闸阀
Silk Mouth Resilient-Seated
Gate Valve (Z15X)



1119
磁性锁式丝口弹性座封闸阀
Magnetic Locking Silk Mouth
Resilient-Seated Gate Valve (Z15X)



1120
铸铁硬密封闸阀
Iron Casting Rigidity
Sealing Gate Valve (Z41T)



3101
铸钢硬密封闸阀
Cast Steel Gate Valve
(Z41H)

蝶阀系列
BUTTERFLY VALVE SERIES



1501
对夹式中线蝶阀
Wafer Center Line-Type
Butterfly Valve (D71X)



1502
对夹式蜗轮中线蝶阀
Wafer Worm Gear Center
Line-Type Butterfly Valve
(D371X)



1512
法兰式蜗轮中线蝶阀
Stretch Type Turbine Flange
Butterfly Valve (D341X)



3504
对夹式蜗轮三偏心蝶阀
Butt-Clamped Worm Wheel-Driven
Three-Eccentric Center Butterfly
Valve (D373H)

止回阀系列
CHECK VALVE SERIES



1401
消声止回阀
Muffle Check Valve (H41X)



1403
橡胶瓣止回阀
Rubber Flap Check Valve (H44X)



1406
滑动滚式止回阀
Sliding Roller Type Check Valve
(HQ41X)



3401
旋启式止回阀
Swing Check Valve (H44H)

水力控制阀系列
HYDRAULIC CONTROL VALVE SERIES



1601
遥控浮球阀
Remote Control Float Ball Valve
J745X-16Q(100X-16)



1602
减压稳压阀
Pressure Reducing Valve
Y42X-16Q(200X-16)



1603
缓闭式止回阀
Slow Close Check Valve
HH741X-16Q(300X-16)



1605
持压/泄压阀
Pressure Relief Valve
A742X-16Q(500X-16)

过滤器
FILTER



1701
铸铁过滤器
Y Filters (GL41H-16Q)



3606
铸钢过滤器
Cast Steel Strainer (GL41H-16C)



1803
数字锁定平衡阀
Digital Locked Balancing Valve
(SP45F-16)



3801
KPF 平衡阀
KPF Balance Valve (KPF-16C)

其它系列
OTHER SERIES



3210
法兰球阀
Flange Type Ball Valve (Q41f)



3301
铸钢截止阀
Cast Steel Stop Valve (J41H-16C)



1801
复合式快速排(进)气阀
Composite Quick Exhaust/
Inlet Valve



1805
自力式压差控制阀
Pressure Difference Self-Control
Valve (ZYC-16)



1807
防污隔断阀
The Anti Pollution Isolating
Valve (HS41X-16Q)



1808
倒流防止器
Side Flow Preventer



1806
橡胶软接头
Flexible rubber joint



3802
波纹补偿器
Corrugated Compensator



3807
限位伸缩接头
Limit Flexible Adapter

青铜阀门系列
BRONZE VALVE SERIES



128

青铜闸阀
Bronze Gate Valve
(Z15W-20T)



288

青铜球阀
Bronze Ball Valve
(Q11F-20T)



388

青铜截止阀
Bronze Stop Valve
(J11W-20T)



608

青铜过滤器
Bronze Strainer
(GL-20T)

黄铜阀门系列
BRASS VALVE SERIES



116

黄铜异径闸阀
Brass Reduced Gate Valve
(Z15W-16T)



125

黄铜锁式闸阀
Brass Lockable Gate Valve
(Z15W-16T)



216

黄铜球阀
Brass Ball Valve (Q11F-20T)



213

黄铜球阀
Brass Ball Valve (Q11F-20T)



260

黄铜测温球阀
Measuring Temperature Brass
Ball Valve (Q11F-16T)



256

黄铜保温球阀
Brass Heat Preserve Valve
(Q11F-16T)



257

小球阀
Brass Mini Ball Valve
(Q31F-16T)



258A

黄铜球阀
Brass Ball Valve
(Q11F-16T)



251

黄铜内外螺纹球阀
Brass Ball Valve MF
(Q11F-16T)

黄铜阀门系列
BRASS VALVE SERIES



202

黄铜外螺纹活接头球阀
Brass Male Union Ball Valve
(Q31F-16T)



274

黄铜双头卡套球阀
Brass Ball Valve With Connectors
(Q19F-16T)



275

黄铜内螺纹单头卡套球阀
Brass Ball Valve With Connector
(Q19F-16T)



282

暖气三通球阀
Brass 3-Way Ball Valve
(For Heated-air Use) (Q35F-16T)



302

黄铜截止阀
Brass Stop Valve (J11F-16T) Gate
Valve (Z15W-16T)



310

黄铜锁式截止阀
Brass Stop Valve With Lock
(J11W-16T)



383

黄铜带刻度锁式调节阀
Brass Lockable Adjustable Valve
(J11W-16T)



705X

黄铜排气阀
Brass Exhausting Valve



127

黄铜带止回双活接头闸阀
Brass Non-return Gate Valve
With Connectors (Z35W-16T)



292

黄铜球阀
Brass Ball Valve
(Q11F-16T)



343

黄铜回水锁断阀
Brass Check Backwater Valve
(J34W-16T)



344

黄铜回水锁断阀
Brass Check Backwater Valve
(J31W-16T)



T118

黄铜铝塑管接头
Brass PPR Pipe Fitting



- 在产品保修期内及寿命期之内保证提供需方所需的备件。
- 我方保证需方的时间要求，选派专业的工程技术人员到产品安装现场协助安装、调试工作，直到产品正常使用。
- 产品发货后，供方承诺十八个月的质量保证期，并保证产品寿命期内的维修，当需方需要时，保证接到通知后在二十四小时内，派专业的维修人员到达现场。当需方按规定的方式、方法正常操作使用时，若出现产品设计、材料或工艺质量造成的损坏由供方负责免费修理，更换部分零部件以至更新产品。
- 急用户所急，想用户所想，备有大量库存，随时满足客户需求。做到库房搬到家，服务做到家的宗旨。
- Offer the store what our customer demand in the period of guarantee.
- Detail the professional technician help the customers setting and debugging the professional technician.
- Help the customers setting and debugging the product until the machine use normally. If our customers suffer olosing for our design, material, or quality of product, we will repair for your product free of change.
- We think what our customers think, our company has a mass of in stock, and we are satisfied your demands monmently. We can offer our product and service to where you demands.



服务理念

优质 专业 健康

Service Concept

High quality, Professional, Healthiness

本着合作、创新、优质服务和健康的经营理念，建立健全完善的销售网络，配合高效务实的销售团队，提供良好的售后服务，同一些国内大型工程合作，并指定为奥运主体育场工程使用产品。

We observe cooperation, innovations, high-quality services and healthy business concept has established a perfect sales network, and with efficient and practical sales team, provide excellent aftersales services. Cooperation with some of the large projects in China, our products are appointed to be used for main gymnasiums of Olympic Games 2008.



目前公司销售网络遍布全国32个省市自治区，在北京、上海、广州、重庆、南京、郑州、沈阳、福州、杭州、长沙、济南等地设立了分公司或办事处，销售网点近400家，保证产品的及时送达，提供优质周到的送货及售后服务。

Jiekelong has sales network which covers 32 provinces and municipalities, set up branch office in Beijing, Shanghai, Guangzhou, Chongqing, Nanjing, Zhengzhou, Shenyang, Fuzhou, Hangzhou, Changsha, Jinan and etc., which in total open about 400 sales outlets. In this way, we can provide you on-time delivery and excellent after-sales service.

服务过的部分代表性工程

SOME REPRESENTATIVE ENGINEERING SERVICES

北京奥运主体育场(鸟巢)
奥运村
奥运媒体中心
北京电视台
丰台体育馆
中央组织部办公楼
北京国际金融中心
北京国际会展中心
北京科技会展中心
北京电视台新址
北京天通苑
清华同方科技广场
中海紫金苑
千鹤家园
时代家园
北京新世界广场
北京顺义国际学校
(北京)世界大学生运动村
北京地铁复八线枢纽工程
安全部9528工程
内蒙古自治区人民医院
乌兰察布市中心医院
内蒙古自治区科技馆新馆
内蒙古留学生创业园
呼市东岸国际
包头颐和观海
西藏人民医院
西藏人民政府

上海环球金融中心(亚洲第一高楼)
上海月星环球商业中心
上海普陀区体育馆
上海莱福士广场
上海虹口SOHO项目
上海移动通讯大楼
上海佘山高尔夫别墅
上海水清木华花园
上海客运中心
上海滨江花园
上海新时空广场
上海中凯城市之光
上海仁恒滨江花园
上海崇明水网工程
上海南汇水网工程

广州南方通信大楼
广州金田广场
广州邮电大厦

广州市锦绣生态园
广州火车站
广州中信广场
广东沃尔玛超市
深圳宝安机场
深圳星河传说
深圳远洋城
深圳福田区区委办公楼
深圳自来水公司
珠海自来水公司
深圳市大万水厂
罗湖区罗芳体育馆
海南省国税办公大楼
海口环球大酒店
三亚喜来登大酒店
三亚高尔夫大酒店
广西保利城
广西华南城
广西荣和中央公园
广西荣和东盟国际
广西融晟公园大地
广西保利龙腾上园
广西保利童心缘
广西江宇世纪城
广西正恒国际广场

浙江省邵逸夫医院
浙江省第二医院
浙江省疾病预防控制中心
杭州市第一人民医院
杭州广利大厦
杭州广电中心
杭州万银国际
杭州燕金国际
杭州华功发展大厦
杭州圣奥大厦
杭州光邸国际
衢州恒大御景半岛
嘉兴江南摩尔国际商业城
嘉兴市中环广场
嘉兴市武警医院
嘉兴市高校园区
湖州市政府办公大楼
湖州市自来水总公司
正泰集团办公大楼
德力西集团办公大楼
台州日报集团办公大楼
世贸集团福州世贸中心

泰禾集团泰禾广场
名城地产东江滨名城港湾
福耀玻璃工业集团股份有限公司
泉州晚报大楼
福建石狮恒大名都
福州五一广场
福建海峡国际会展中心
福州万达广场
福州火车南站
厦门佰翔酒店
厦门国际会展中心

山东三联阳光舜城
山东齐鲁医院
山东省广播电视大学住宅楼
山东省行政学院
齐鲁世纪园
武警山东省总队住宅楼
济南领绣城
济南高铁站
济南水网改造工程
济南军区通信总站住宅楼
济南奥体中心
济南自来水水表工程
济南旧城改造工程
淄博市体育中心
淄博中央公园
枣庄花园小区
威海市行政审批中心大楼
威海山花集团
威海金猴集团金色家园
保利里院里
青岛中心
青岛万象城
青岛碧海花园
海尔新厂房扩建工程
青岛银都景园
青岛流亭机场
滨洲医学院烟台分院
烟台葡醍海湾
烟台山水商务大厦
烟台海天花园
菏泽南华康城
魏桥职工小区

武汉东湖高科技会展中心
武汉市第一医院
武汉尚隆地球村

武汉军械士官学院
武汉新华饭店
武汉财政厅大厦
长沙广电中心
长沙保利国际广场
长沙韵达广场
长沙华远·华中心
长沙自来水公司
长沙红星美凯龙
长沙西客站
株洲美的高科办公大楼
襄樊供电局大楼

合肥市自来水公司
合肥中科院办公楼
合肥元一希尔登大酒店
南昌大学城
南昌市政府接待中心
合肥恒大中央广场
淮北恒大名都
吉安恒大帝景
马鞍山恒大御景湾

哈尔滨富力城
哈尔滨松花江凯莱商务酒店
哈尔滨金谷大厦
哈尔滨动车组客运西站
哈尔滨哈西万达广场
哈尔滨松北区科技大厦
大庆创业城
大庆绿地金融中心
大庆绿城分公司
大连九州华美达酒店
大连实德集团
大连顺迈集团
大连热电集团
大连新希望花园
大连世纪经典大厦
大连圣亚海洋世界
大连都市海景大厦
大连医科大学附属一院
沈阳全运村
沈阳新世界花园
沈阳喜来登大酒店
沈阳文特国际公寓
沈阳河畔新城
沈阳中润花园
沈阳绿岛森林公园

假日伊丽雅特湾
沈阳陆军总院门诊综合楼
沈阳地税局综合楼
长春恒大御景
长春翡翠华庭
长春绿地中央公园
长春华大城
长春远洋北岸夏纳小镇
长春东北亚购物中心
长春保利罗兰香谷
长春中信城
长春万科上东区
长春长影世纪村
长春吉林大学
长春理工大学
长春医大一院
长春一汽大众
长春卷烟厂
长春财富大厦
吉林市世贸广场
吉林省政府枫林园
吉林亚泰樱花苑

西安天郎地产集团公司
西安富力城地产
西安华远海蓝城
西安华远君城
龙湖锦城置业有限公司
西安邮政中心局大厦
西安飞机制造有限公司住宅大楼
西安解放军总参研究所
西安地铁二号线
西安咸阳机场
洛阳宝龙地产
洛阳建业龙城
洛阳市华阳国际大酒店
河南省第一人民医院
河南科技大学
郑州第一人民医院附属医院
安阳水天苑
太原市富力城
山西省大剧院
山西省省政府办公楼
太原市十二院城
太原市鼎晨地产
太原市中正房地产
太原市双喜城
山西鑫华通房地产

太原裕峰花园
太原市星河湾
太原中保集团辰憬花园
太原富士康工业园
南京雨润国际广场
南京金陵饭店
苏州体育中心
江都洪泉医院
无锡锡州花园酒店
无锡市第一人民医院
无锡市公安局
启东恒大海上海威尼斯
盐城恒大名都
宿迁恒大华府
江阴恒大御景

龙湖重庆后工
龙湖重庆时代天街
重庆上海城
重庆(申基)威斯汀酒店
重庆时代广场
重庆国资委大厦
重庆大学教学楼
重庆市质量技术监督局办公大楼
重庆市第五人民医院
成都中海城南1号
成都宏誉环球汇
成都华侨城
成都中天盈誉峰
成都西部国际金融中心
成都东方广场
成都环球时代广场
成都富森美国际家居国际广场
成都嘉宇·天琢城
成都富士康员工公寓
成都川航广场
成都华侨凤凰国际
成都自来水公司
成都国际会展中心
成都南部附中心
成都锦江国际
四川广播电视中心
四川联运枢纽大厦
九寨沟黄龙贵宾楼
贵阳国际会议展览中心
贵阳市自来水公司